



The most complete line of...

System Alarms

Float Switches

On-Site Accessories

Control Panels

C A T A L O G



Enviro-Flo Inc.
P.O. Box 321161
151 Custom Drive
Flowood, MS 39232
Office: 601-939-2966 Fax: 601-939-3526
E-mail: joe@enviro-flo.net

ABOUT SEPTIC PRODUCTS INCORPORATED...

It is our vision to be a highly visible company known for offering the most complete line of floats, alarms, controls and other on-site products at the best market price. To show you our commitment, SPI is determined to ship your catalog orders within 24 hours. It is our goal to set a new standard of service for this industry.

SPI is focused on learning first hand the needs of the installers and distributors. Our Mission is to provide innovative, practical, and top-quality products to a quickly growing and changing market. Located on 3 acres in Ashland, Ohio, SPI is organized to satisfy our customer's needs.

-Rod Mitchell

SUGGESTIONS

To help SPI deliver the exact product you are interested in, please order by the part number and/or the model number that is found in the following price pages. If you are interested in having SPI supply a special feature or modification to existing products, please call your local Representative or SPI at 419-282-5933. For information on our Volume Purchase Agreements, Freight Paid Programs, and Return Policies, please contact your local Representative or SPI at 419-282-5933.

All prices, products, designs and materials are subject to change without notice.

SHIPPING INFORMATION

Standard catalog items are expected to be shipped in 24 hours from receipt of order. Special requests and large blanket orders will be shipped in five business days from receipt of order. Please specify all next day and second day air orders to ensure proper handling.

TERMS OF SALE

Shipments will be made via best carrier, unless clearly requested otherwise. Ask about qualifying for free freight on orders of \$1,800.00 NET or more. One copy of the invoice will be mailed. A 15% restocking fee will be applied to all returned goods that are non-warranty. All units include full installation instructions. Standard terms are Net 30.

WARRANTY POLICY

SPI warrants to the original consumer that this product shall be free of manufacturing defects and workmanship for a period of three-years after the date of consumer purchase for all mechanical and mercury float switches, and two-years after the date of consumer purchase for all other items. During the specified time period and subject to the conditions set forth by SPI, products will be repaired or replaced, for the original consumer, any part that proves to be defective due to defective materials or improper manufacturing.

SPI shall not be liable under this Warranty if any of its products have not been properly installed; damage from lightning or severe weather; if it has been disassembled, modified, abused or tampered with; if the electrical cord has been cut or spliced; or if the name plate or tag has been removed.

The consumer shall take responsibility and assume full expense for removal, reinstallation, and freight. All items to be replaced under this warranty must be returned to SPI, or such place as designated by SPI. All warranties shall be void if the installation or service of products is performed by anyone other than a Licensed Electrician.

To return a product for warranty, please contact SPI at 419-282-5933 to obtain a return material authorization (RMA) number and a Return Goods Authorization Form (RGA).

TABLE OF CONTENTS

Category	Pages
Cover/General Ordering Information	1-2
Table Of Contents/Featured Products	3
High Water Alarm Data	4-13
Caddy Box/Junction Box Data	14-17
Control Duty Float Switch Data	18-19
Pump Duty Float Switch Data	20-24
General Float Switch Data	25
Drip and Aerobic Control Panels	26-27
Simplex Control Panel Data	28-29
Duplex Control Panel Data	30-31
Time Does - Grinder Control Panel Data	32-33
Single & Three Phase Panel Configuration Chart	34-35
Back Cover and PVC Adaptaflex Fittings	36



New Item

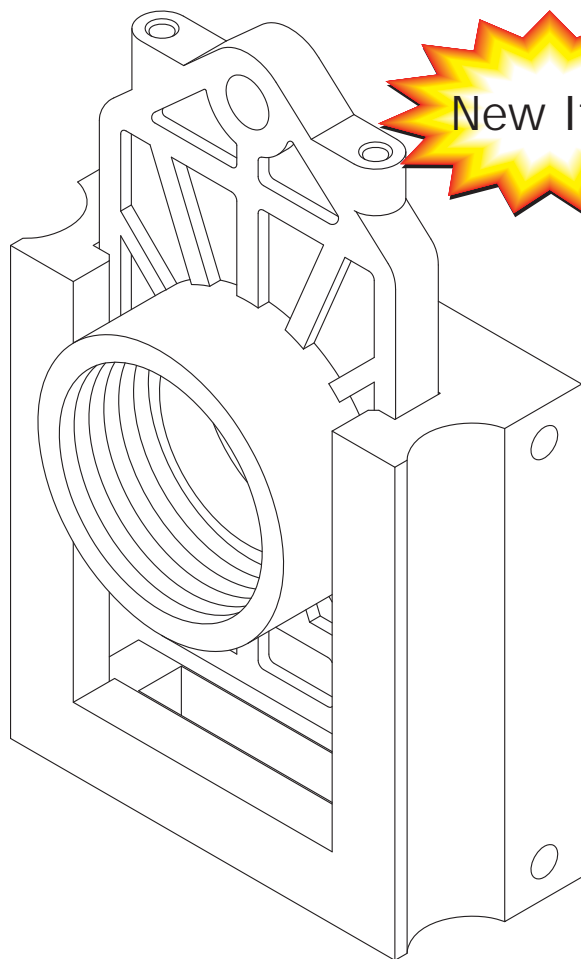

BENEFITS & FEATURES

- Rugged glass filled thermoplastic
- 2" Discharge/non-corrosive design
- Supports pump up to 75 lbs.
- Side design allows trouble free pump removal years later
- Time saving product design

Part Number	Model Number	Description - Slide Connect	Shipping Weight	Suggested List Price
60A600	SC-600	Corrosion Free Slide Connect	5 lbs.	\$69.00

Plug-In Pedestal Alarm System

BENEFITS & FEATURES

- New low profile design with external silence switch
- Easy to access cover
- Rugged water tight enclosure rated for outdoor use
- 120 / 240 VAC receptacles for plugging in the pump and switch
- Built-in high water alarm with horn and light (test feature included)
- 120 VAC with 9 VAC battery back-up alarm, complete with automatic reset
- Spacious panel designed with 120 VAC or 240 VAC pump power supply and 120 VAC alarm power
- Mechanical alarm float switch with 20' cord
- Large access port with gas/liquid tight seal for cord connections
- Test/normal silence switch (external)
- Auxiliary contacts standard
- Optional push breaker, cycle counter, etm
- 2 year limited warranty

New Low Profile Design

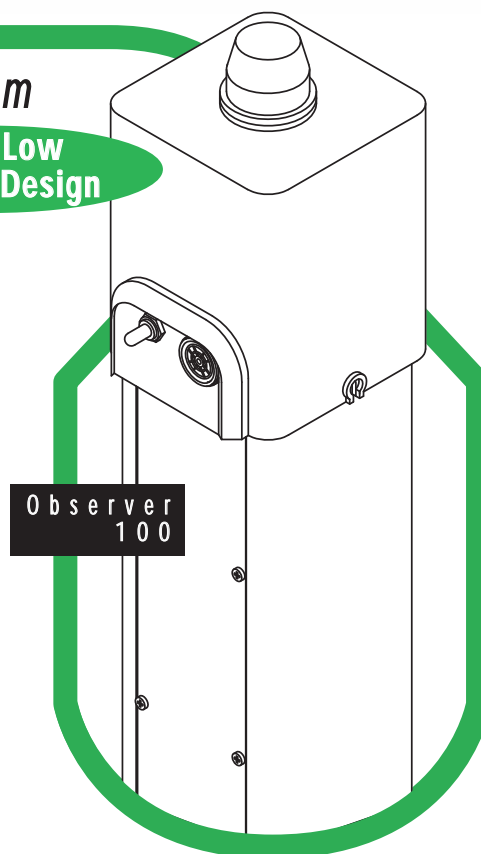

SPECIFICATIONS

Enclosure Dimensions	6 X 6 X 7
Overall Dimensions	6 X 6 X 35
Enclosure	Nema 3R, UV protected PVC rated for outdoor use
Alarm Horn	85 db at 10'
Battery Back-Up	9 VDC for alarm horn
Light	10 watts 120 VAC
Receptacle	120 VAC or 240 VAC
Full Load Amps	12
Weight	11 lbs.
Alarm Float	20' mechanical float (normally open)
Pump Voltage	120 / 240 VAC, 60 Hz single phase
Alarm Voltage	120 VAC, 60 Hz single phase
Standard Auxiliary Contacts	240 VAC, 5 amps max resistive / 60 Hz

For additional details, see next page.

Call about other special pedestal options: floats options, cycle counters; ETM's; pushbreakers and more.

Part Number	Model Number	Supply Voltage	Description - Observer 100 Series Pedestal Alarm System	NEMA Rating	Shipping Weight	Suggested List Price
10A100	SMD-10	120	Pedestal alarm with large light, alarm auxiliary contacts, audible horn, 120 V pump receptacle, 9 V battery back-up, and 20' alarm float, external silence switch.	3R	11 lbs.	\$233.00
10A101	SMD-11	230	Pedestal alarm with large light, alarm auxiliary contacts, audible horn, 240 V pump receptacle, 9 V battery back-up, and 20' alarm float, external silence switch.	3R	11 lbs.	\$258.00
10A106	SMD-30	120	Pedestal alarm with large light, alarm auxiliary contacts, audible horn, 120 V pump receptacle, 9 V battery back-up, and 30' alarm float, external silence switch.	3R	11 lbs.	\$236.25
10A102	SMD-KT		Riser mounting Kit			\$25.00
10A103	6" Kit		6" Nipple Kit			\$23.30

Call or fax us your order today. Phone: 601-939-2966 Fax: 601-939-3526 E-mail: joe@enviro-flo.net

Plug-In Pedestal Alarm System

Installation information

Observer
100

TYPICAL INSTALLATION

DIMENSIONS

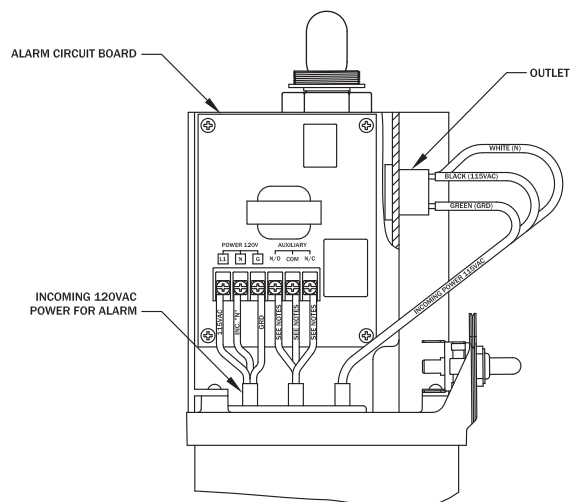
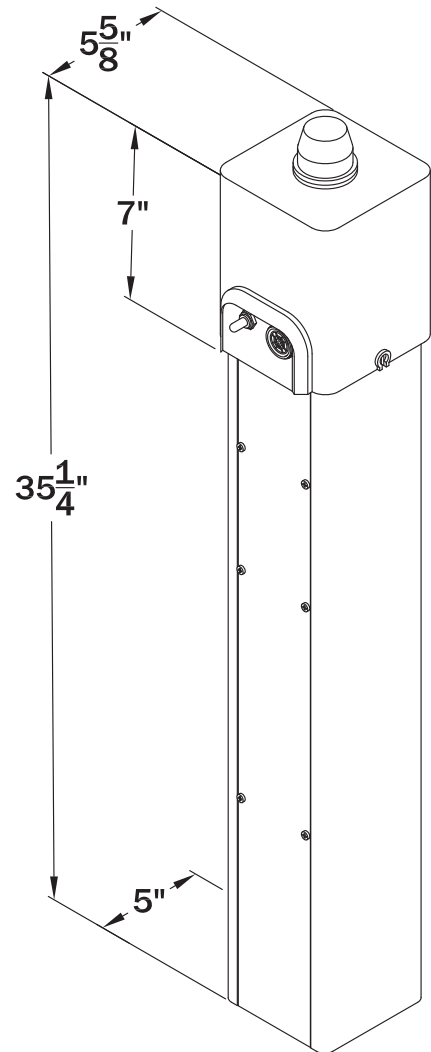
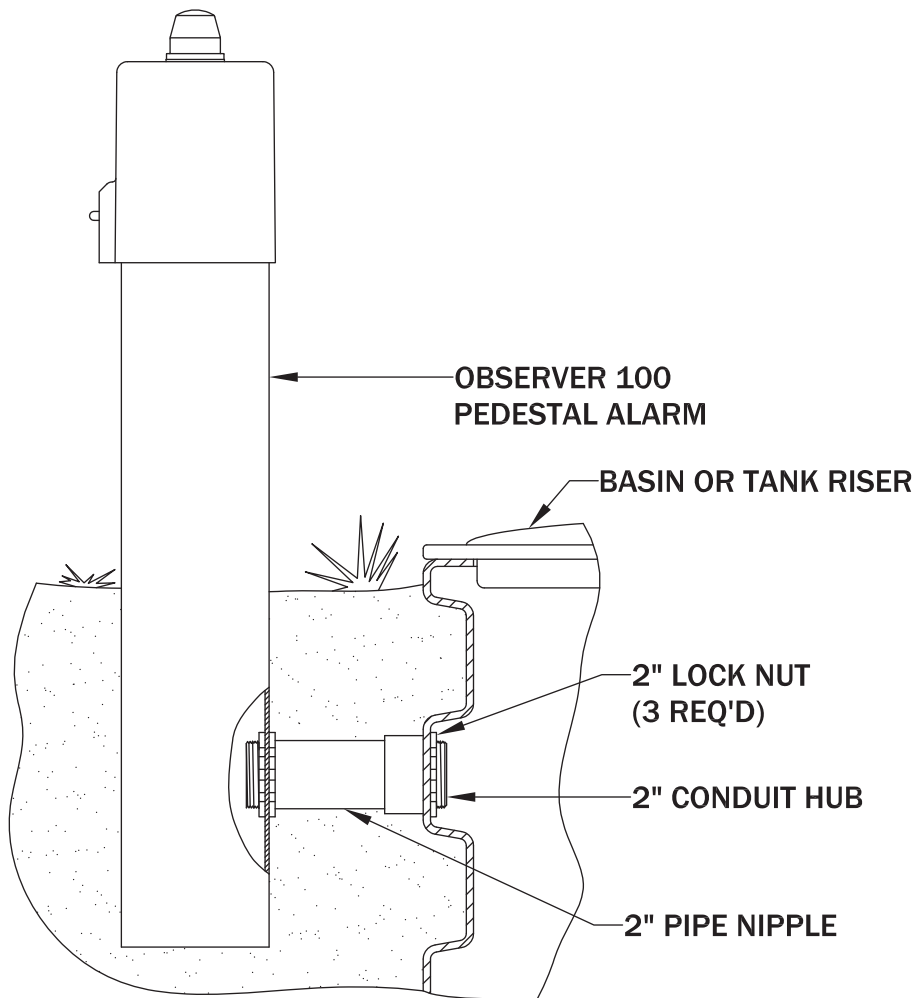

WIRING DIAGRAM

NOTES: TWO SEPARATE POWER SUPPLIES ARE RECOMMENDED - ONE FOR THE ALARM CIRCUIT AND ONE FOR THE PUMP CIRCUIT. ON THE 120VAC OUTLET - WIRES ARE SOLDERED TO THE OUTLET TO ALLOW FOR CONNECTING INCOMING POWER SUPPLY. BE SURE TO USE WIRE NUTS OR CONNECTORS WITH SILICONE SEALANT OR SIMILAR FOR WATER TIGHT CONNECTION. WHEN USING AUXILIARY CONTACTS FOR REMOTE ALARM OR DEVICES: BE SURE REQUIRED CURRENT IS LESS THAN 3 AMPS. THE "COM" OR COMMON TERMINAL MUST BE POWERED. TO TURN "ON" A REMOTE DEVICE OR ALARM DURING A HIGH WATER ALARM CONNECT TO "NO" OR THE NORMALLY OPEN POSITION. TO TURN "OFF" A REMOTE DEVICE OR ALARM DURING A HIGH WATER ALARM CONNECT TO "NC" OR THE NORMALLY CLOSED POSITION.

Indoor High Water Alarm with Battery Back-Up

BENEFITS & FEATURES

- Durable Nema 1 thermoplastic enclosure rated for indoor use
- Red "alarm" light, green "on" light and 85 decibel horn at 10 feet
- Mechanical alarm float switch included (15' cord)
- Alarm test and horn silence button with auto reset – 120 VAC
- The alarm will continue to work even when the primary power fails due to our battery back-up feature
- Auxiliary dry contacts are standard
- External quick connect terminal block for easy float installation
- Two-year limited warranty

SPECIFICATIONS

Dimensions	6" X 3-3/4" X 2-1/2 "
Enclosure	Nema 1 thermoplastic (external mounting feet)
Horn	85 db at 10'
Weight	2.5 lbs with float
Voltage	Primary: 120 VAC, 9 VAC secondary, 60 Hz (alarm condition 2.5 watts max)
Power Cord	6 feet, 120 VAC
Float Switch	15' mechanical float with tie strap (normally open)
Float Switch Connection	Quick connect float connection. Do not apply power. Class two output, 12 VAC
Standard Auxiliary Contacts	240 VAC, 5 amp max resistive / 60 Hz

Observer
200



Part Number	Model Number	Supply Voltage	Observer 200 Series Alarm Systems Indoor High Water Alarm with Battery Back-Up	NEMA Rating	Shipping Weight	Suggested List Price
10A200	SMD-21H	120	Indoor alarm with audible and visual alarm, 15' mechanical alarm float, battery back-up, 6 foot power cord, auxiliary dry contacts, and quick snap terminal connections. (High Level)	1X	4 lbs.	\$93.00
10A201	SMD-21L	120	Indoor alarm with audible and visual alarm, 15' mechanical alarm float, battery back-up, 6 foot power cord, auxiliary dry contacts, and quick snap terminal connections. (Low Level)	1X	4 lbs.	\$93.00
10A202	SMD-21N	120	Indoor alarm with audible and visual alarm, battery back-up, 6 foot power cord, auxiliary dry contacts, and quick snap terminal connections. (No Float Switch)	1X	2 lbs.	\$83.00
10A204	SMD-21HM	120	Indoor alarm with audible and visual alarm, 15' mercury alarm float, battery back-up, 6 foot power cord, auxiliary dry contacts, and quick snap terminal connections. (High Level)	1X	4 lbs.	\$93.00
10A206	SMD-21HM PC		Indoor alarm with audible and visual alarm, 15' mercury alarm float, battery back-up, 6 foot power cord, auxiliary dry contacts, SST pipe clamp and quick snap terminal connections. (High Level)	1X	4 lbs.	\$97.50

Indoor High Water Alarm with Battery Back-Up

Installation information

TYPICAL INSTALLATION

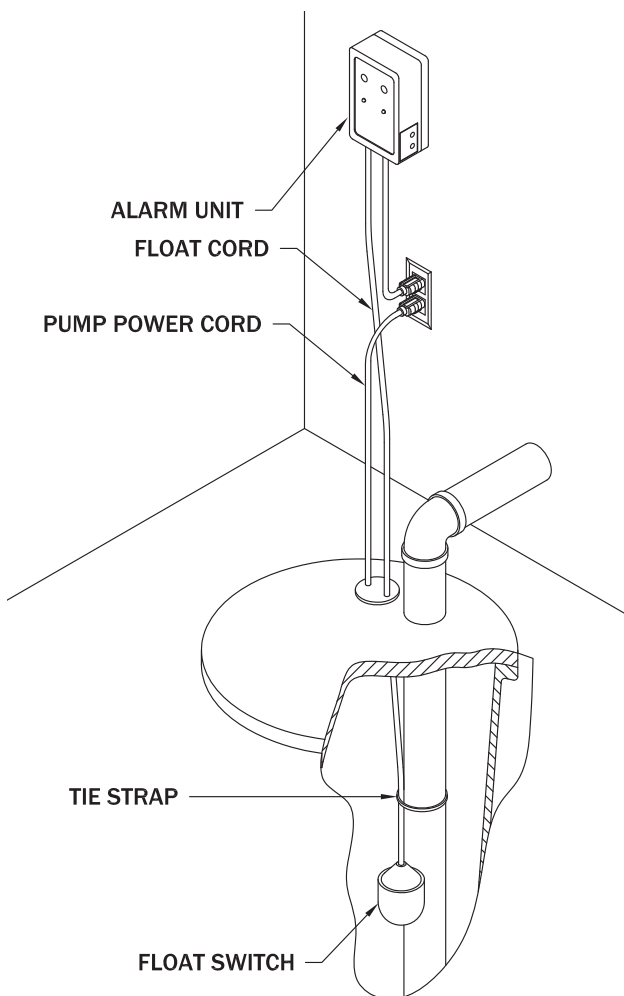

Observer
200

DIMENSIONS

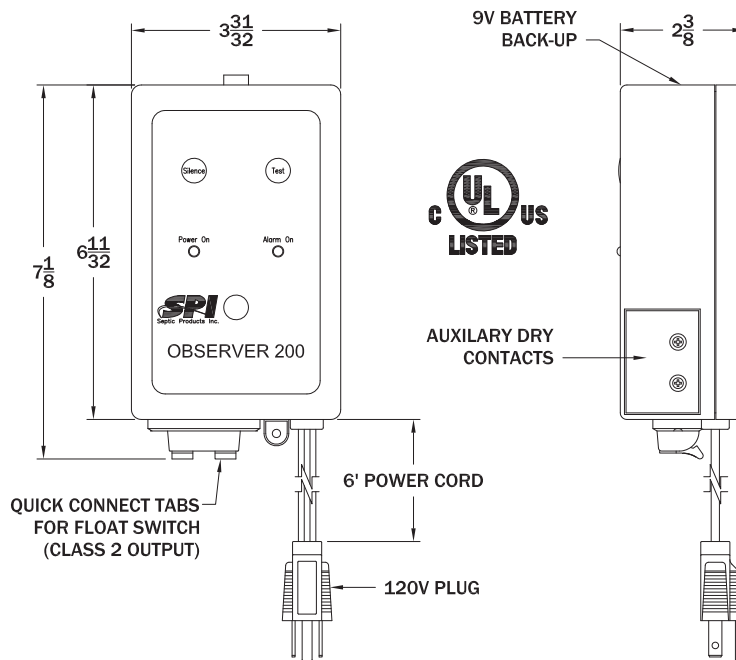

VISUAL AID

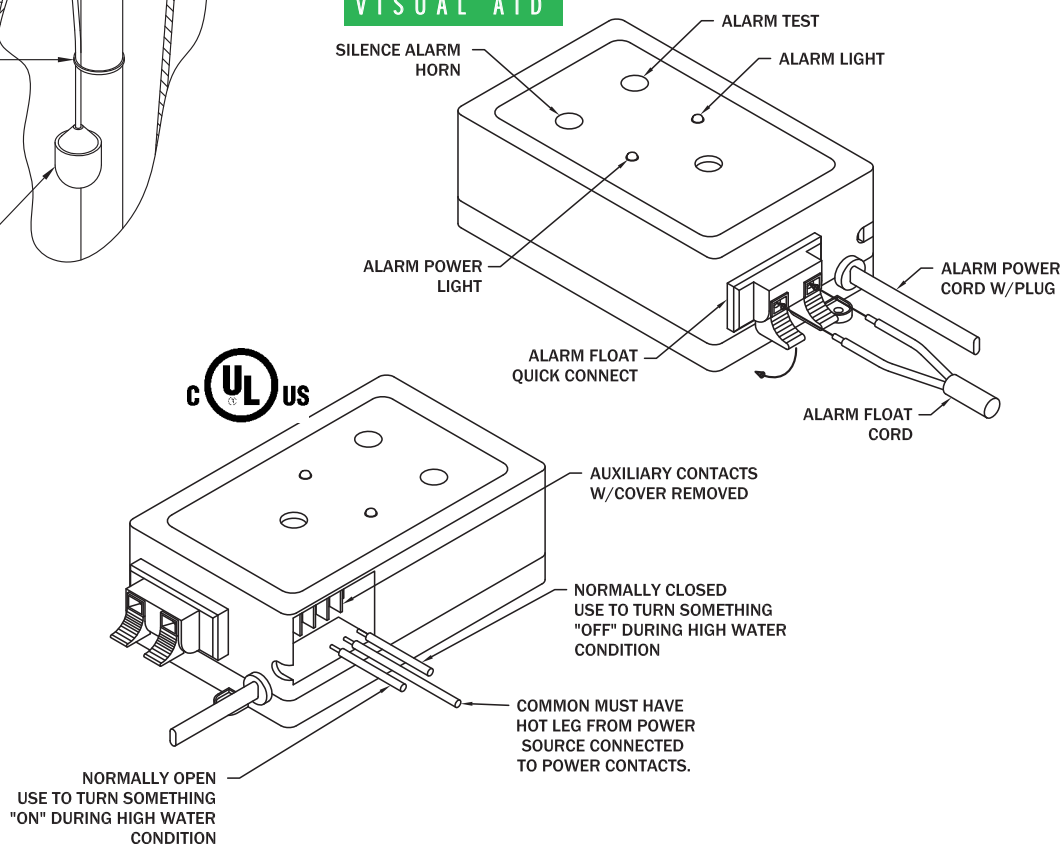

Indoor High Water Alarm

BENEFITS & FEATURES

- Nema 1 steel enclosure rated for indoor use
- Red "alarm" light, green "on" light and 85 decibel horn at 10 feet
- Mechanical alarm float switch included (15' cord)
- Alarm test and horn silence switch – 120/240 VAC
- External quick connect terminal block for easy float installation
- UL listed alarm system 120 VAC only
- Two-year limited warranty

SPECIFICATIONS

Dimensions	6" X 4" X 2-1/2"
Enclosure	Nema 1 metal (external mounting feet)
Horn	85 db at 10'
Weight	2.5 lbs. with float
Voltage	Primary: 120 VAC, 12 VAC secondary, 60 Hz (alarm condition 2.5 watts max)
Power Cord	6 feet, 120 VAC
Float Switch	15' mechanical float with tie strap (normally open)
Float Switch Connection	Quick connect float connection. Do not apply power. Class two output, 12 VAC

Observer
300



Part Number	Model Number	Supply Voltage	Observer 300 Series Alarm Systems Indoor High Water Alarm	NEMA Rating	Shipping Weight	Suggested List Price
10A300	SMD-31H	120	Indoor alarm with audible and visual alarm, 15' alarm float, 6 foot power cord, and quick snap terminal connections. (High Level)	1X	4.5 lbs.	\$98.50
10A301	SMD-31L	120	Indoor alarm with audible and visual alarm, 15' alarm float, 6 foot power cord, and quick snap terminal connections. (Low Level)	1X	4.5 lbs.	\$98.50
10A302	SMD-31N	120	Indoor alarm with audible and visual alarm, 6 foot power cord, and quick snap terminal connections. (No Float Switch)	1X	2.5 lbs.	\$87.10
10A303	SMD-32H	240	Indoor alarm with audible and visual alarm, 15' alarm float, 6 foot power cord, and quick snap terminal connections. (High Level)	1X	4.5 lbs.	\$129.00
10A304	SMD-32L	240	Indoor alarm with audible and visual alarm, 15' alarm float, 6 foot power cord, and quick snap terminal connections. (Low Level)	1X	4.5 lbs.	\$129.00
10A305	SMD-32N	240	Indoor alarm with audible and visual alarm, 6 foot power cord, and quick snap terminal connections. (No Float Switch)	1X	2.5 lbs.	\$118.00
10A306	SMD-31H-PC	240	Indoor alarm with audible and visual alarm, 15' mercury alarm float, 6 foot power cord, SST pipe clamp and quick snap terminal connections. (High Level)	1X	4.5 lbs.	\$102.50

Indoor High Water Alarm

Installation information

Observer
300

TYPICAL INSTALLATION

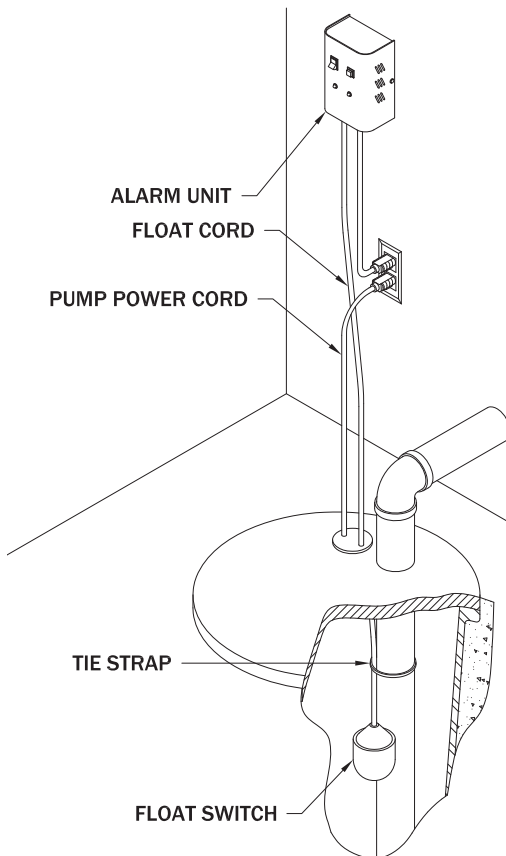

QUICK CONNECT TABS
FOR FLOAT SWITCH
(CLASS 2 OUTPUT)

DIMENSIONS

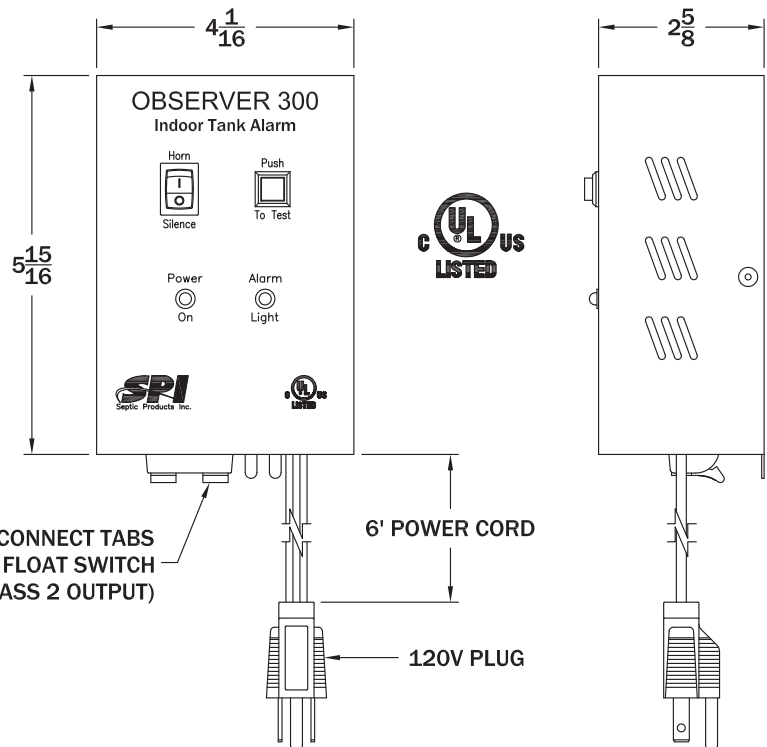

VISUAL AID

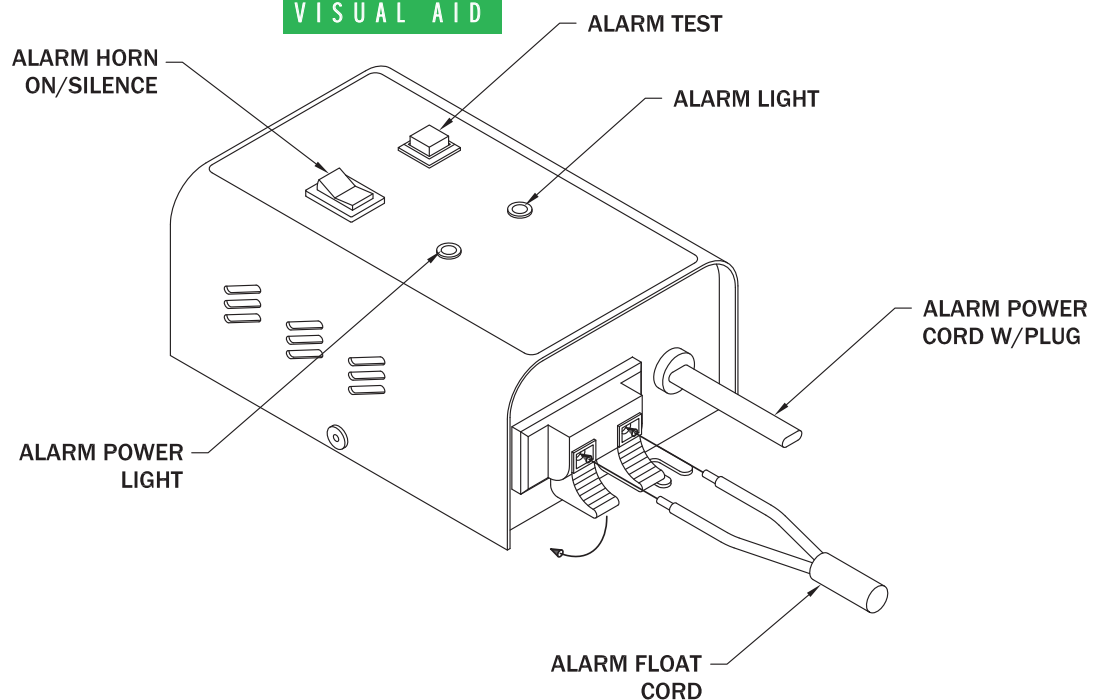

Indoor/Outdoor High Water Alarm

BENEFITS & FEATURES

- Nema 3R water-tight enclosure rated for indoor and outdoor use
- Automatic alarm reset, horn silence button, and alarm test button
- 360 degree visible alarm light
- Alarm horn sounds to 85 decibels at 10'
- Mechanical alarm float switch included (15' cord)
- Auxiliary dry contacts are standard
- SST mounting screws included
- UL listed alarm system
- Two-year limited warranty

Observer
400



SPECIFICATIONS

Dimensions	6.5" X 4.5" X 3" (external mounting feet)
Enclosure	Nema 3R weatherproof thermoplastic (water-tight)
Horn	85 db at 10'
Weight	3.5 lbs. with float
Alarm Voltage	Primary: 120 VAC, 12 VAC secondary, 60 Hz (alarm condition 15 watts max)
Float Switch	15' mechanical float with tie strap (normally open)
Float Switch Connection	Internal terminal strip
Power Cord	6 foot power cord (optional)
Alarm Light	360 degree visible
Auxiliary Contacts	240 VAC, 5 amp max resistive / 60 Hz



Part Number	Model Number	Supply Voltage	Observer 400 Series Alarm Systems Indoor/Outdoor High Water Alarm	NEMA Rating	Shipping Weight	Suggested List Price
10A400	SMD-4H	120	Indoor / Outdoor alarm with large light, audible horn, 15' mechanical alarm float, auxiliary dry contacts. (High Level)	3R	5 lbs.	\$150.84
10A401	SMD-4L	120	Indoor / Outdoor alarm with large light, audible horn 15' mechanical alarm float, auxiliary dry contacts. (Low Level)	3R	5 lbs.	\$150.84
10A402	SMD-4N	120	Indoor / Outdoor alarm with large light, audible horn, auxiliary dry contacts. (No Float Switch)	3R	3 lbs.	\$140.81
10A403	SMD-4HPC	120	Indoor / Outdoor alarm with large light, audible horn, 15' mechanical alarm float, auxiliary dry contacts. 6' Powercord and cord grips. (High Level)	3R	5.5 lbs.	\$171.88

Indoor/Outdoor High Water Alarm

Installation information

Observer
400

TYPICAL INSTALLATION

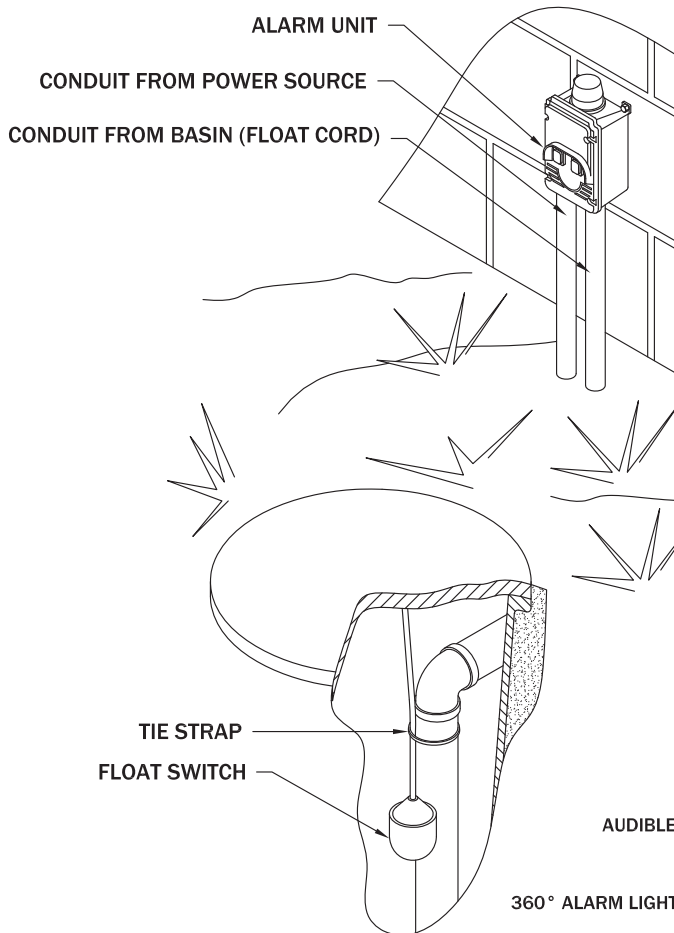

DIMENSIONS

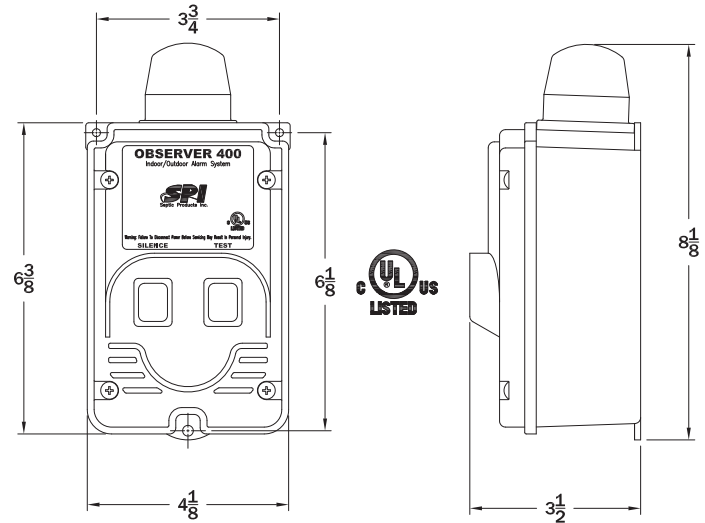

VISUAL AID

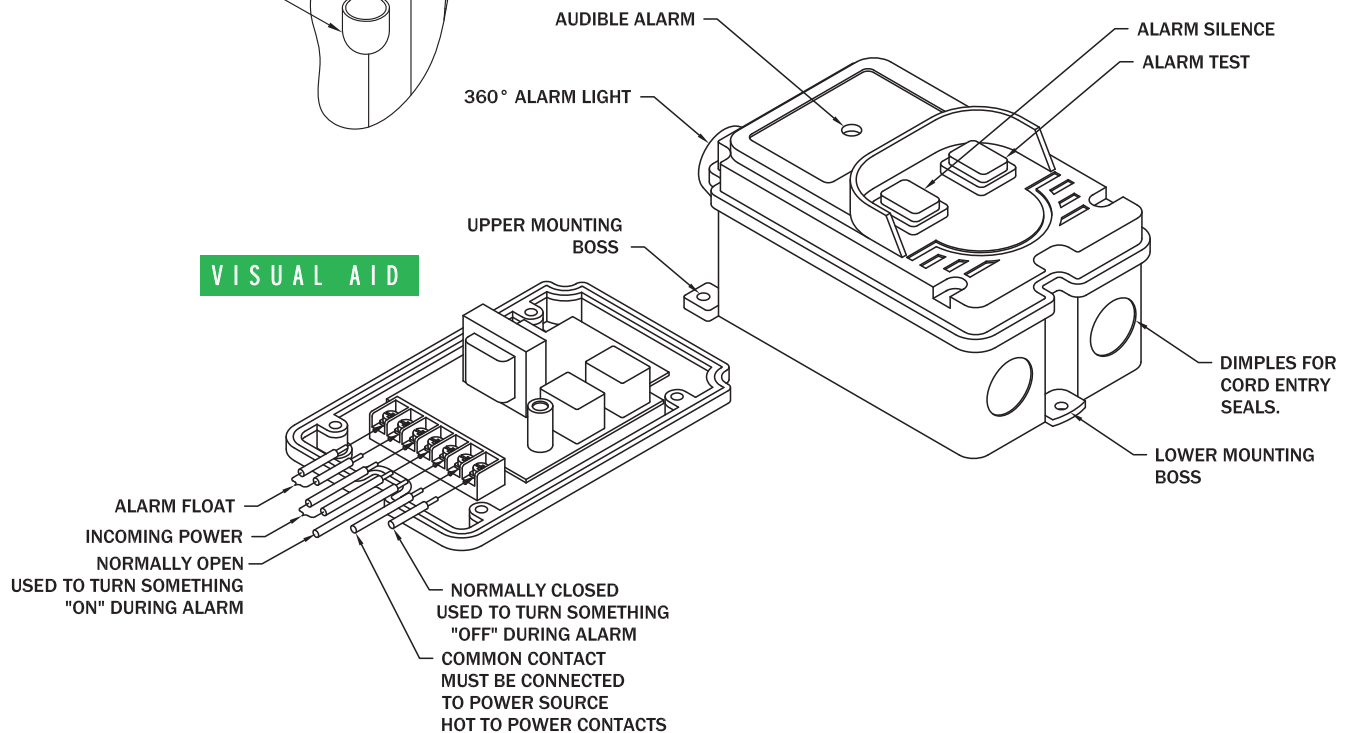

Indoor / Outdoor High Water Alarm

BENEFITS & FEATURES

- Nema 4X type thermoplastic enclosure designed for indoor / outdoor use
- 360 degree red "alarm" light, and alarm horn
- Alarm test button and horn silence button, with auto reset
- Mechanical float switch included (15' cord)
- 6' 120 VAC power cord
- External cord grips for easy installation
- Two-year limited warranty

SPECIFICATIONS

Dimensions	5.5" x 3.75" x 3.75" (external mounting feet)
Enclosure	Nema 4X type thermoplastic
Horn	85 db at 10' solid tone alert
Weight	3.8 lbs. with float
Alarm Voltage	Primary: 120 VAC, 12 VAC secondary, 60 Hz (alarm condition 6.5 watts max)
Power Cord	120 VAC, 6 feet
Alarm Light	360 degree visible - 2" tall
Float Switch	15' mechanical float with tie strap. (normally open)
Float Switch Connection	Internal terminal strip

Observer
500



Part Number	Model Number	Supply Voltage	Observer 500 Series Alarm Systems Indoor/Outdoor High Water Alarm	NEMA Rating	Shipping Weight	Suggested List Price
10A500	SMD-5H	120	Outdoor alarm with large light, audible horn, 15' mechanical alarm float, 6 foot power cord, alarm test switch and horn silence (high level).	4X	5.5 lbs.	\$130.00
10A502	SMD-5HWW	120	Outdoor alarm with large light, audible horn, 20' mechanical alarm float, 6 foot power cord, alarm test switch and horn silence (high level float with weight attached).	4X	6.5 lbs	\$135.00
10A504	SMD-5H-30	120	Outdoor alarm with large light, audible horn, 30' mechanical alarm float, 6 foot power cord, alarm test switch and horn silence (high level float).	4X	6.5 lbs	\$138.00
10A505	SMD-5H-M	120	Outdoor alarm with large light, audible horn, 15' mercury alarm float, 6 foot power cord, alarm test switch and horn silence.	4X	6.5 lbs	\$131.00
10A507	SMD-5H-30-I	120	Outdoor alarm with large light, audible horn, 30' mechanical alarm float installed, 6 foot power cord, alarm test switch and horn silence, (high level float).	4X	6.5 lbs	\$142.00

Indoor/Outdoor High Water Alarm

Installation information

Observer
500

TYPICAL INSTALLATION

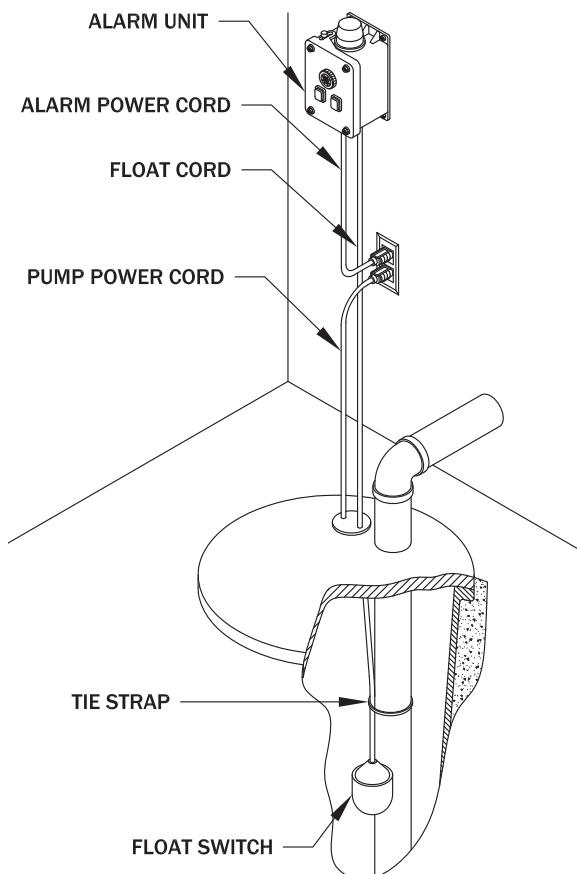

DIMENSIONS

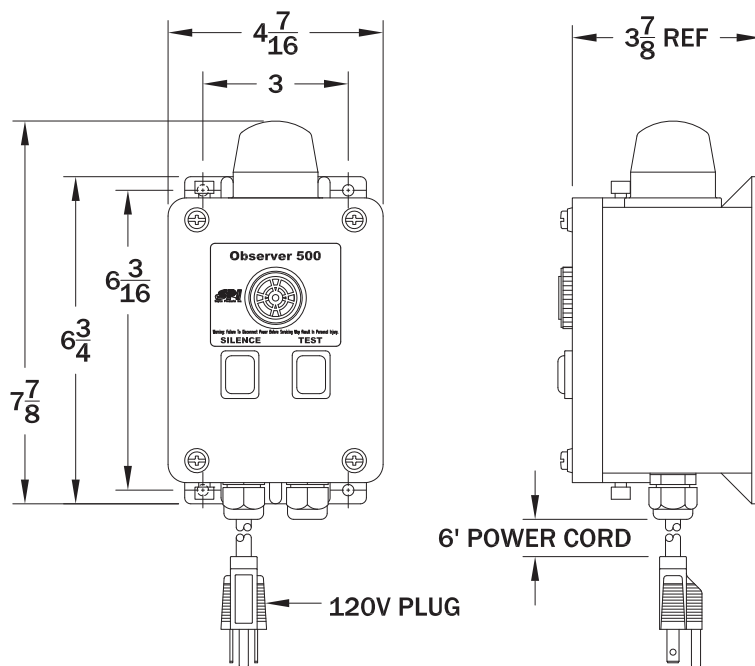

VISUAL AID

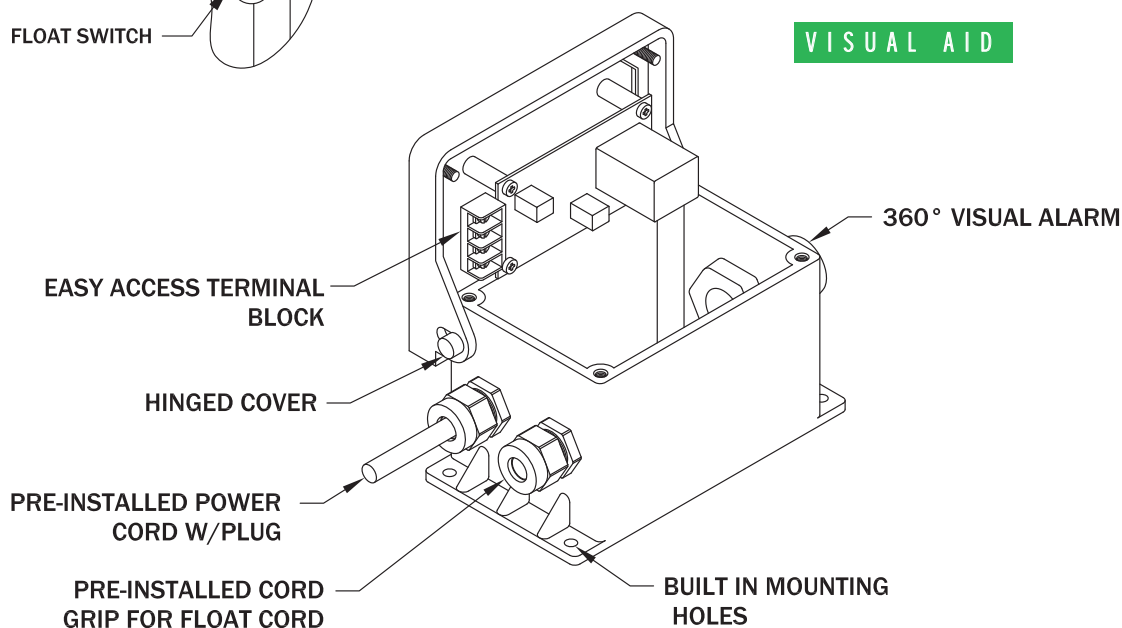

Plug-In Junction Box

Caddy Box Series



BENEFITS & FEATURES

- Nema 4x watertight enclosure with captive bolted hinged door
- Built-in receptacle for pump and pump switch (120 VAC or 240 VAC)
- Gas-tight cord seal and PVC mounting hardware included
- Terminal strip and ground screw for power supply and alarm system
- Available with Observer 300 or 400 series alarm and required float
- Two-year limited warranty



120 V

SPECIFICATIONS

Enclosure Dimensions	7.25" X 5.5" X 5"
Overall Dimensions	8-3/4" X 5-1/4" X 5"
Enclosure	Nema 4X, UV protected
Voltage	120 VAC single phase 1 HP or 240 VAC 2 HP; single phase
Weight	5.3 lbs. — 10 lbs.
Pump Receptacle	120 V or 240 V

CADDY BOX

Part Number	Model Number	Supply Voltage	Caddy Box Plug-In System	NEMA Rating	Shipping Weight	Suggested List Price
10A600	CB-1NFA	120	Plug-In Junction Box, No Float, No Alarm.	4X	3.5 lbs.	\$135.10
10A601	CB-2NFA	240	Plug-In Junction Box, No Float, No Alarm.	4X	3.5 lbs.	\$146.55
10A602	CB-1300M	120	Plug-In Junction Box, Observer 300 indoor alarm, 15' alarm float & 15' mercury pump float.	4X	8.0 lbs.	\$277.07
10A603	CB-2300M	240	Plug-In Junction Box, Observer 300 indoor alarm (120V), 15' alarm float & 15' mercury pump float.	4X	8.0 lbs.	\$288.51
10A606	CB-1300DF	120	Plug-In Junction Box, Observer 300 indoor alarm, 15' alarm float & 15' mercury double pump float.	4X	8.5 lbs.	\$334.31
10A607	CB-2300DF	240	Plug-In Junction Box, Observer 300 indoor alarm (120V), 15' alarm float & 15' mercury double pump float.	4X	8.5 lbs.	\$345.76
10A608	CB-1400M	120	Plug-In Junction Box, Observer 400 indoor/outdoor alarm, 15' alarm float & 15' mercury pump float.	4X	8.5 lbs.	\$322.86
10A609	CB-1400MC	120	Plug-In Junction Box, Observer 400 indoor/outdoor alarm, 15' alarm float & 15' mechanical pump float.	4X	8.5 lbs.	\$322.86
10A610	CB-1400DF	120	Plug-In Junction Box, Observer 400 indoor/outdoor alarm, 15' alarm float & 15' mercury double pump float.	4X	9.0 lbs.	\$380.11
10A6011	CB-1300	120	Plug-In Junction Box, Observer 300 indoor alarm, & 15' alarm float.	4X	6.0 lbs.	\$233.56
10A6012	CB-2300	240	Plug-In Junction Box, Observer 300 indoor alarm (120V), & 15' alarm float.	4X	6.0 lbs.	\$256.46

ALARM CADDY BOX

Part Number	Model Number	Supply Voltage	Alarm Caddy Box Plug-In System	NEMA Rating	Shipping Weight	Suggested List Price
10A650	ACB-1NF	120	Alarm Plug -In Junction Box, No Float, No Alarm	4X	3.5	\$280.50
10A651	ACB-1PDM	120	Alarm Plug -In Junction Box, 20' Alarm Float, 20' Pump Float, Built in Alarm	4X	3.5	\$354.92

Caddy Box Series

INCLUDED PARTS

DETAILS

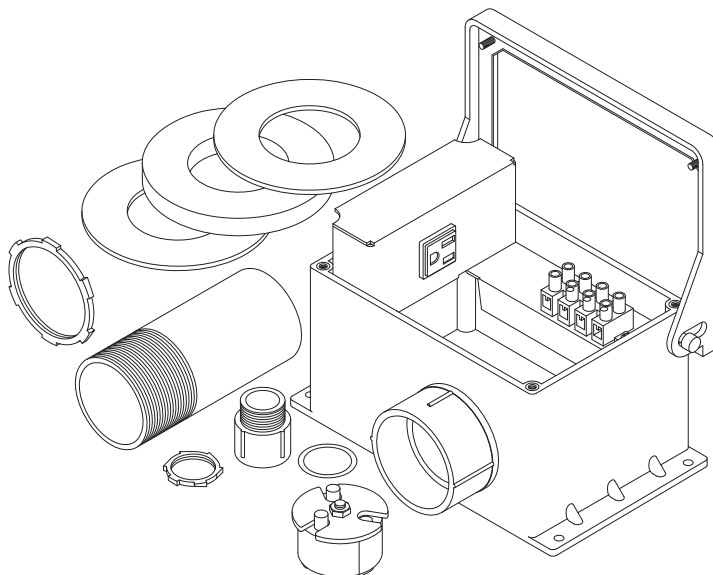
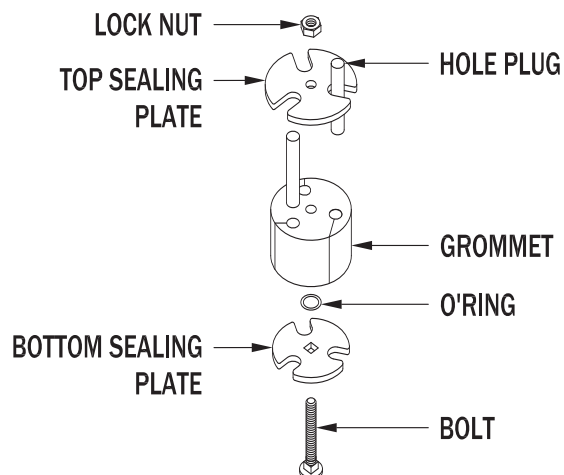

DIMENSIONS

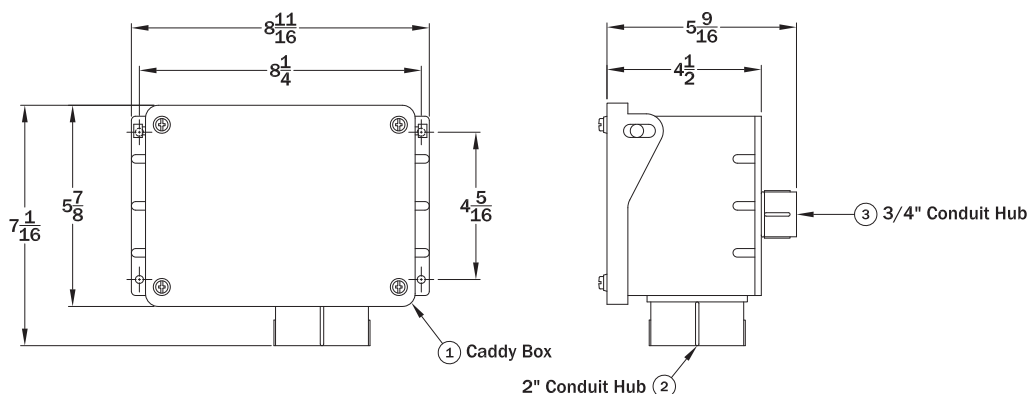

TYPICAL INSTALLATION

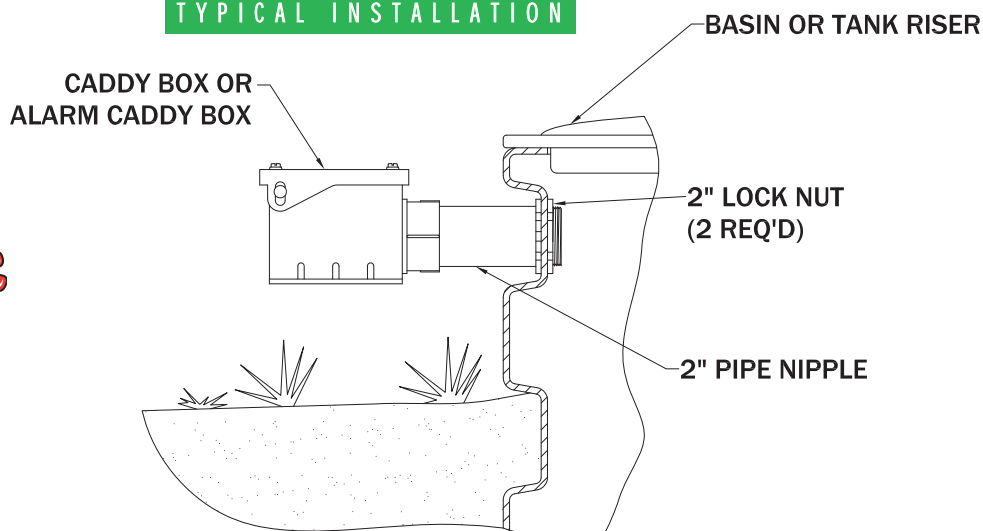

Custom Junction/Connection Boxes

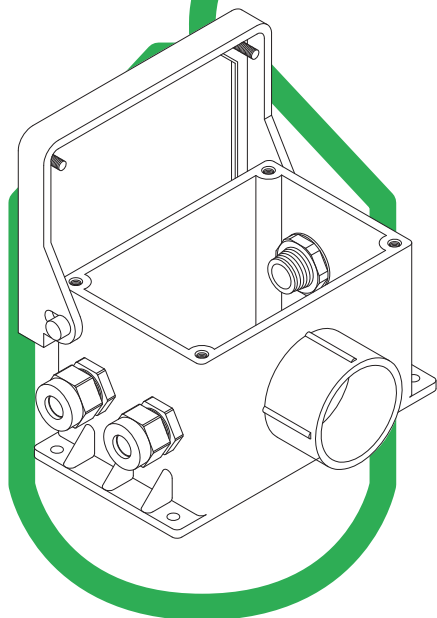

BENEFITS & FEATURES

- Durable NEMA 6P Thermoplastic Enclosure
- 4x Rated Cord Sealing Grips
- Available w/Conduit Entry Fitting
- Multiple Configurations Available
- Customized per Customer Specification
- Suitable for Indoor or Outdoor Use



Part Number	Model Number	Junction Boxes	NEMA Rating	Shipping Weight	Suggested List Price
10A700	JB-3NHC	Box Only - 3.5" X 5.5" X 4" simplex (no connectors or hub installed)	4X	1.5 lbs.	\$39.32
10A701	JB-33	Simplex- 3.5" X 5.5" X 4" (1.5" conduit hub / 3 ea - 1/2" connectors)	4X	2.0 lbs.	\$70.78
10A702	JB-34	Simplex- 3.5" X 5.5" X 4" (1.5" conduit hub / 4ea - 1/2" connectors)	4X	2.0 lbs.	\$77.52
10A703	JB-35	Simplex- 3.5" X 5.5" X 4" (1.5" conduit hub / 5ea - 1/2" connectors)	4X	2.0 lbs.	\$83.14
10A704	JB-5NHC	Box Only - 5.5" X 7.25" X 4.25" simplex (no connectors or hub installed)	4X	2.5 lbs.	\$49.43
10A705	JB-54	Simplex- 5.5" X 7.25" X 4.25" (2" conduit hub / 4 ea. - 1/2" connectors)	4X	3.0 lbs.	\$85.39
10A706	JB-55	Simplex- 5.5" X 7.25" X 4.25" (2" conduit hub / 5 ea. - 1/2" connectors)	4X	3.0 lbs.	\$94.37
10A707	JB-542	Simplex- 5.5" X 7.25" X 4.25" (2" conduit hub / 4 ea. - 1/2" connectors, 2 ea 3/4" connectors)	4X	3.0 lbs.	\$110.10
10A708	JB-8NHC	Box Only - 8" X 8" X 4" Duplex (no connectors or hub installed)	4X	3.5 lbs.	\$106.73
10A709	JB-85	Duplex - 8" X 8" X 4" (1.5" conduit hub / 5 ea. - 1/2" connectors)	4X	4.0 lbs.	\$150.55
10A710	JB-842	Duplex - 8" X 8" X 4" (2" conduit hub / 4 ea. - 1/2" connectors,	4X	4.0 lbs.	\$167.40
10A711	JB-config	Please call for your custom connector placement and pricing.	4X	-	-

Custom Junction Boxes Built to Your Specifications Upon Request.

TYPICAL DIMENSIONS

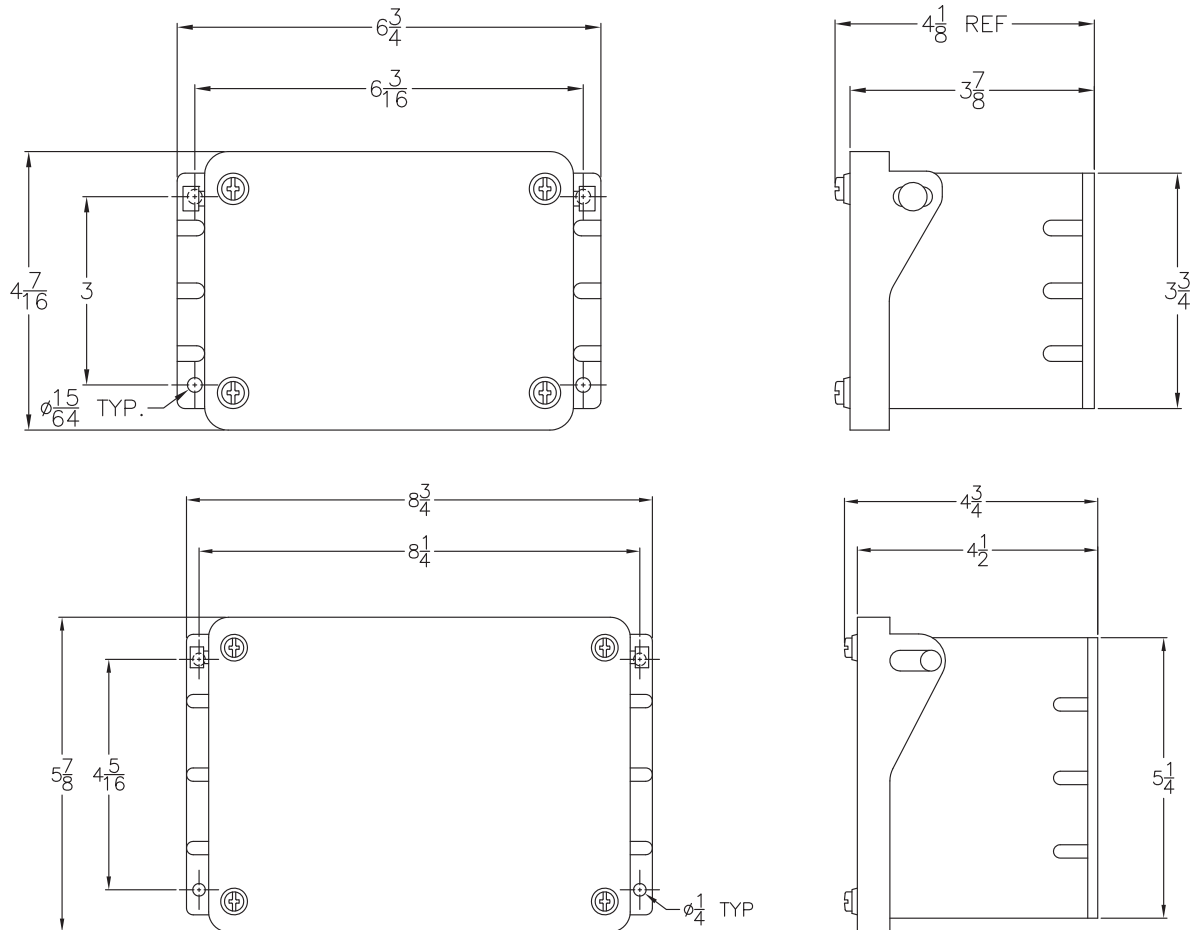

SAMPLE JUNCTION/CONNECTION BOX CONFIGURATIONS

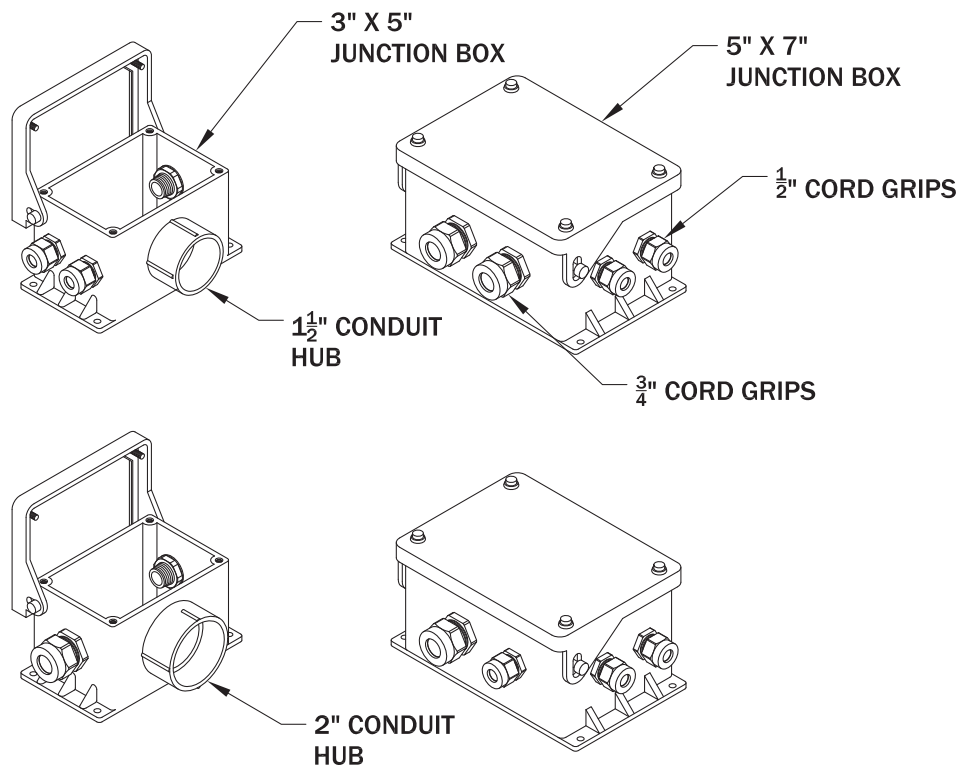

BENEFITS & FEATURES

- Mechanically activated pilot duty control switches
- Narrow angle float not sensitive to rotation
- For use in water and sewage applications
- Available for pump up and pump down applications
- 16 gauge, 2 conductor, SJOW water resistant (CPE) material
- Maximum 5 amps @ 120 VAC / 240 VAC
- 10', 15', 20', 30', 50' cord
- Individually boxed and includes external weight or SST pipe mount assembly
- For use on control panels and alarm circuits only
- UL / CSA
- 3 year limited warranty



Weight
Option



SST Clamp

Pilot



Pump Down Mechanical control duty, 10 degree narrow angle float switch designed for use on control panels and alarms

Part Number	Description	Cord Length	Voltage	Ext. Weight	Weight lbs.	List Price	Notes: 5 amp 120/240 VAC; 16/2 SJOW wire; individually boxed, SST pipe mount assembly, or externally weighted.
20A601	10CMDPC	10'	120/240	no	1.6	\$27.46	
20A602	10CMDSW	10'	120/240	yes	2.8	\$32.97	
20A605	15CMDPC	15'	120/240	no	1.9	\$29.67	
20A606	15CMDSW	15'	120/240	yes	3	\$36.28	
20A609	20CMDPC	20'	120/240	no	2.7	\$32.97	
20A610	20CMDSW	20'	120/240	yes	3.3	\$38.49	
20A613	30CMDPC	30'	120/240	no	2.6	\$38.49	
20A614	30CMDSW	30'	120/240	yes	3.8	\$42.00	
20A617	50CMDPC	50'	120/240	no	3.5	\$44.00	
20A618	50CMDSW	50'	120/240	yes	4.7	\$60.54	

All floats that are not sold with an external weight are supplied with an SST pipe mount assembly kit.

PUMP DOWN designates normally open contacts for emptying.

Description Meaning

1. # = Cord Length
2. C = Cord Duty
3. M = Mechanical
4. D or U = Pump Up or Pump Down
5. PC or SW = Pipe Clamp or Weight



* All floats can be purchased as "Bulk" for \$0.60 less than list price. Please change item description to a B. (i.e. 20A601 would be 20B601).

Pump Up Mechanical control duty, 10 degree narrow angle float switch designed for use on control panels and alarms

Part Number	Description	Cord Length	Voltage	Ext. Weight	Weight lbs.	List Price	Notes: 5 amp 120/240 VAC; 16/2 SJOW wire; individually boxed, SST pipe mount assembly, or externally weighted.
20A603	10CMUPC	10'	120/240	no	1.6	\$27.46	
20A604	10CMUSW	10'	120/240	yes	2.8	\$32.97	
20A607	15CMUPC	15'	120/240	no	1.9	\$29.67	
20A608	15CMUSW	15'	120/240	yes	3	\$36.28	
20A611	20CMUPC	20'	120/240	no	2.7	\$32.97	
20A612	20CMUSW	20'	120/240	yes	3.3	\$38.49	
20A615	30CMUPC	30'	120/240	no	2.6	\$38.49	
20A616	30CMUSW	30'	120/240	yes	3.8	\$42.00	
20A619	50CMUPC	50'	120/240	no	3.5	\$44.00	
20A620	50CMUSW	50'	120/240	yes	4.7	\$60.54	

All floats that are not sold with an external weight are supplied with an SST pipe mount assembly kit.

PUMP UP designates normally closed contacts for filling.

Description Meaning

1. # = Cord Length
2. C = Cord Duty
3. M = Mechanical
4. D or U = Pump Up or Pump Down
5. PC or SW = Pipe Clamp or Weight

* All floats can be purchased as "Bulk" for \$0.60 less than list price. Please change item description to a B. (i.e. 20A601 would be 20B601).

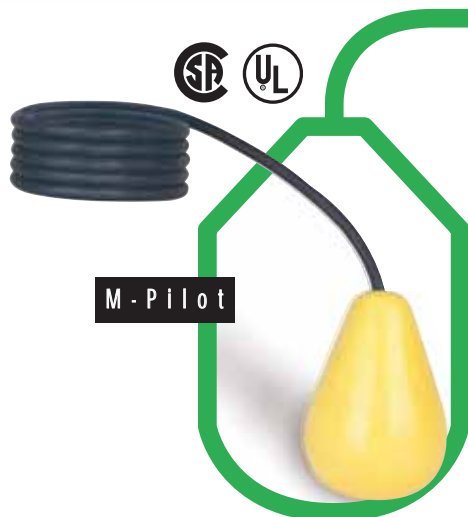

S S T C l a m p



W e i g h t
O p t i o n

BENEFITS & FEATURES

- Mercury activated pilot duty control switches
- Narrow angle float not sensitive to rotation
- For use in water and sewage applications
- Available for pump up and pump down applications
- 18 gauge, 2 conductor, SJ00W water resistant (CPE) material
- Maximum 10 amps @ 120 VAC / 240 VAC
- 10', 15', 20', 30', 50' cord
- Individually boxed and includes external weight or SST pipe mount assembly
- For use on control panels and alarm circuits only
- UL / cUL
- 3 year limited warranty

* Not recommended for use in drinking water applications.

Pump Down Mercury control duty, 10 degree narrow-angle float switch designed for use on control panels and alarms

Part Number	Description	Cord Length	Voltage	Ext. Weight	Weight lbs.	List Price	Notes: 5 amp 120/240 VAC; 18/2 SJ0W wire; individually boxed, SST pipe mount assembly, or externally weighted.
20A701	10CRDPC	10'	120/240	no	1.6	\$29.77	
20A702	10CRDSW	10'	120/240	yes	2.8	\$36.38	
20A705	15CRDPC	15'	120/240	no	1.9	\$31.97	All floats that are not sold with an external weight are supplied with an SST pipe mount assembly kit.
20A706	15CRDSW	15'	120/240	yes	3.3	\$38.59	
20A709	20CRDPC	20'	120/240	no	2.2	\$35.28	
20A710	20CRDSW	20'	120/240	yes	3.3	\$40.79	PUMP DOWN designates normally open contacts for emptying.
20A713	30CRDPC	30'	120/240	no	2.6	\$40.79	Description Meaning
20A714	30CRDSW	30'	120/240	yes	3.8	\$46.31	1. # = Cord Length
20A717	50CRDPC	50'	120/240	no	3.5	\$56.23	2. C = Control Duty
20A718	50CRDSW	50'	120/240	yes	4.7	\$57.33	3. R = Mercury
							4. D or U = Pump Up or Pump Down
							5. PC or SW = Pipe Clamp or Weight

* All floats can be purchased as "Bulk" for \$0.60 less than list price. Please change item description to a B. (i.e. 20A701 would be 20B701).

Pump Up Mercury control duty, 10 degree narrow-angle float switch designed for use on control panels and alarms

Part Number	Description	Cord Length	Voltage	Ext. Weight	Weight lbs.	List Price	Notes: 5 amp 120/240 VAC; 18/2 SJ0W wire; individually boxed, SST pipe mount assembly, or externally weighted.
20A703	10CRUPC	10'	120/240	no	1.6	\$29.77	
20A704	10CRUSW	10'	120/240	yes	2.8	\$36.38	
20A707	15CRUPC	15'	120/240	no	1.9	\$31.97	All floats that are not sold with an external weight are supplied with an SST pipe mount assembly kit.
20A708	15CRUSW	15'	120/240	yes	3.3	\$38.59	
20A711	20CRUPC	20'	120/240	no	2.2	\$35.28	
20A712	20CRUSW	20'	120/240	yes	3.3	\$40.79	PUMP UP designates normally closed contacts for filling.
20A715	30CRUPC	30'	120/240	no	2.6	\$40.79	Description Meaning
20A716	30CRUSW	30'	120/240	yes	3.8	\$46.31	1. # = Cord Length
20A719	50CRUPC	50'	120/240	no	3.5	\$56.23	2. C = Control Duty
20A720	50CRUSW	50'	120/240	yes	4.7	\$57.33	3. R = Mercury
							4. D or U = Pump Up or Pump Down
							5. PC or SW = Pipe Clamp or Weight

* All floats can be purchased as "Bulk" for \$0.60 less than list price. Please change item description to a B. (i.e. 20A701 would be 20B701).

Standard Duty Mechanical Float Switch (1/2 Hp 120 v / 1 Hp 240 v)



BENEFITS & FEATURES

- Mechanically activated wide angle float to directly control a pump
- Not sensitive to rotation or turbulence
- For use in water and sewage applications
- Controls pumps up to 1/2 HP at 120 VAC, and 1 HP at 240 VAC
- Available for pump up and pump down applications
- Adjustable pumping range of 6 to 36 inches
- 16 gauge, 2 conductor, SJOW water resistant (CPE) material
- Max pump running current, 13 amps
- Max pump starting current, 59 amps
- 10', 15', 20', 30', 50' cord with or without piggyback plug
- Individually boxed and includes SST pipe mount assembly
- UL / CSA
- 3 year limited warranty

Pump Down



Mechanically activated, 90 degree wide-angle pump switch designed to control pumps up to 1/2 HP at 120 VAC and 1 HP at 240 VAC

Part Number	Description	Cord Length	Voltage	Plug	Weight lbs.	List Price	Notes: 13 amp 16/2 SJOW wire; individually boxed, SST pipe mount assembly included with all floats.
20A001	10SMDNOP	10'	120/240	no	1.8	\$41.79	PUMP DOWN designates normally open contacts for emptying. Description Meaning 1. # = Cord Length 2. S = Standard Duty 3. M = Mechanical 4. D or U = Pump Up or Pump Down 5. 1 or 2 = 120/240 Volts 6. NOP or WP = No Plug or With Plug
20A002	10SMD1WP	10'	120	yes	2.0	\$47.31	
20A003	10SMD2WP	10'	240	yes	2.0	\$50.17	
20A007	15SMDNOP	15'	120/240	no	2.4	\$44.00	
20A008	15SMD1WP	15'	120	yes	2.6	\$50.61	
20A009	15SMD2WP	15'	240	yes	2.6	\$51.72	
20A013	20SMDNOP	20'	120/240	no	2.6	\$47.31	
20A014	20SMD1WP	20'	120	yes	3.0	\$52.82	
20A015	20SMD2WP	20'	240	yes	3.0	\$53.92	
20A019	30SMDNOP	30'	120/240	no	2.8	\$52.82	
20A020	30SMD1WP	30'	120	yes	3.3	\$58.33	
20A021	30SMD2WP	30'	240	yes	3.3	\$59.43	
20A025	50SMDNOP	50'	120/240	no	4.6	\$69.36	
20A026	50SMD1WP	50'	120	yes	5.2	\$74.43	
20A027	50SMD2WP	50'	240	yes	5.2	\$75.53	

* All floats can be purchased as "Bulk" for \$0.60 less than list price. Please change item description to a B. (i.e. 20A001 would be 20B001).

Pump Up



Mechanically activated, 90 degree wide-angle pump switch designed to control pumps up to 1/2 HP at 120 VAC and 1 HP at 240 VAC

Part Number	Description	Cord Length	Voltage	Plug	Weight lbs.	List Price	Notes: 13 amp 16/2 SJOW wire; individually boxed, SST pipe mount assembly included with all floats.
20A004	10SMUNOP	10'	120/240	no	1.8	\$41.79	PUMP UP designates normally closed contacts for filling. Description Meaning 1. # = Cord Length 2. S = Standard Duty 3. M = Mechanical 4. D or U = Pump Up or Pump Down 5. 1 or 2 = 120/240 Volts 6. NOP or WP = No Plug or With Plug
20A005	10SMU1WP	10'	120	yes	2.0	\$47.31	
20A006	10SMU2WP	10'	240	yes	2.0	\$50.17	
20A010	15SMUNOP	15'	120/240	no	2.4	\$44.00	
20A011	15SMU1WP	15'	120	yes	2.6	\$50.61	
20A012	15SMU2WP	15'	240	yes	2.6	\$51.72	
20A016	20SMUNOP	20'	120/240	no	2.6	\$47.31	
20A017	20SMU1WP	20'	120	yes	3.0	\$52.82	
20A018	20SMU2WP	20'	240	yes	3.0	\$53.92	
20A022	30SMUNOP	30'	120/240	no	2.8	\$52.82	
20A023	30SMU1WP	30'	120	yes	3.3	\$58.33	
20A024	30SMU2WP	30'	240	yes	3.3	\$59.43	
20A028	50SMUNOP	50'	120/240	no	4.6	\$69.36	
20A029	50SMU1WP	50'	120	yes	5.2	\$74.43	
20A030	50SMU2WP	50'	240	yes	5.2	\$75.53	

* All floats can be purchased as "Bulk" for \$0.60 less than list price. Please change item description to a B. (i.e. 20A001 would be 20B001).

BENEFITS & FEATURES

- Mechanically activated wide angle float to directly control a pump
- Not sensitive to rotation or turbulence
- For use in water and sewage applications
- Controls pumps up to 1 HP at 120 VAC, and 2 HP at 240 VAC
- Available for pump up and pump down applications
- Adjustable pumping range of 6 to 36 inches
- 14 gauge, 2 conductor, SJOW water resistant (CPE) material
- Max pump running current, 15 amps
- Max pump starting current, 96 amps
- 10', 15', 20', 30', 50' cord with or without piggyback plug
- Individually boxed and includes SST pipe mount assembly
- UL / CSA
- 3 year limited warranty

Heavy Duty Mechanical Float Switch (1 Hp 120 v/ 2 Hp 240 v)



Pump Down Mechanically activated, 90 degree wide-angle pump switch designed to control pumps up to 1 HP at 120 VAC and 2 HP at 240 VAC.

Part Number	Description	Cord Length	Voltage	Plug	Weight lbs.	List Price
20A101	10HMDNOP	10'	120/240	no	2.0	\$61.30
20A102	10HMD1WP	10'	120	yes	2.2	\$63.50
20A103	10HMD2WP	10'	240	yes	2.2	\$64.61
20A107	15HMDNOP	15'	120/240	no	2.2	\$63.50
20A108	15HMD1WP	15'	120	yes	2.4	\$65.71
20A109	15HMD2WP	15'	240	yes	2.4	\$66.81
20A113	20HMDNOP	20'	120/240	no	2.6	\$67.91
20A114	20HMD1WP	20'	120	yes	2.8	\$70.12
20A115	20HMD2WP	20'	240	yes	2.8	\$71.22
20A119	30HMDNOP	30'	120/240	no	2.8	\$76.73
20A120	30HMD1WP	30'	120	yes	3.4	\$78.94
20A121	30HMD2WP	30'	240	yes	3.4	\$80.04
20A125	50HMDNOP	50'	120/240	no	4.4	\$94.37
20A126	50HMD1WP	50'	120	yes	4.6	\$96.58
20A127	50HMD2WP	50'	240	yes	4.6	\$97.68

Notes: 15 amp 14/2 SJOW wire; individually boxed, SST pipe mount assembly included with all floats.

PUMP DOWN designates normally open contacts for emptying.

Description Meaning

1. # = Cord Length
2. H = Heavy Duty
3. M = Mechanical
4. D or U = Pump Up or Pump Down
5. 1 or 2 = 120/240 Volts
6. NOP or WP = No Plug or With Plug

* All floats can be purchased as "Bulk" for \$0.60 less than list price. Please change item description to a B. (i.e. 20A101 would be 20B101).

Pump Up Mechanically activated, 90 degree wide-angle pump switch designed to control pumps up to 1 HP at 120 VAC and 2 HP at 240 VAC.

Part Number	Description	Cord Length	Voltage	Plug	Weight lbs.	List Price
20A104	10HMUNOP	10'	120/240	no	2.0	\$62.40
20A105	10HMU1WP	10'	120	yes	2.2	\$62.76
20A106	10HMU2WP	10'	240	yes	2.2	\$65.71
20A110	15HMUNOP	15'	120/240	no	2.2	\$64.61
20A111	15HMU1WP	15'	120	yes	2.4	\$66.81
20A112	15HMU2WP	15'	240	yes	2.4	\$67.91
20A116	20HMUNOP	20'	120/240	no	2.6	\$69.02
20A117	20HMU1WP	20'	120	yes	2.8	\$71.22
20A118	20HMU2WP	20'	240	yes	2.8	\$72.32
20A122	30HMUNOP	30'	120/240	no	2.8	\$77.84
20A123	30HMU1WP	30'	120	yes	3.4	\$80.04
20A124	30HMU2WP	30'	240	yes	3.4	\$81.14
20A128	50HMUNOP	50'	120/240	no	4.4	\$95.48
20A129	50HMU1WP	50'	120	yes	4.6	\$97.68
20A130	50HMU2WP	50'	240	yes	4.6	\$98.78

Notes: 15 amp 14/2 SJOW wire; individually boxed, SST pipe mount assembly included with all floats. PUMP UP designates normally closed contacts for filling.

Description Meaning

1. # = Cord Length
2. H = Heavy Duty
3. M = Mechanical
4. D or U = Pump Up or Pump Down
5. 1 or 2 = 120/240 Volts
6. NOP or WP = No Plug or With Plug

*All floats can be purchased as "Bulk" for \$0.60 less than list price. Please change item description to a B. (i.e. 20A101 would be 20B101).

Call or fax us your order today. Phone: 601-939-2966 Fax: 601-939-3526 E-mail: joe@enviro-flo.net

Vertical Mechanical Float Switch (1/2 Hp 120 v / 1 Hp 240 v)

BENEFITS & FEATURES

- Mechanically activated vertical float to directly control a pump
- Not sensitive to rotation or turbulence
- For use in water and sewage applications
- Designed to operate in confined areas
- Controls pumps up to 1/2 HP at 120 VAC, and 1 HP at 240 VAC
- Available for pump down applications
- Adjustable pumping range of 1 to 6 inches
- 16 gauge, 2 conductor, SJOW water resistant (CPE) material
- Max pump running current, 10 amps
- Max pump starting current, 59 amps
- 10', 15', 20', 30' cord with piggyback plug
- Individually boxed and includes SST pipe mount assembly
- UL / CSA
- 3 year limited warranty

Notes: 10 amp 16/2 SJOW wire; individually boxed, SST pipe mount assembly included with all floats.

PUMP DOWN designates normally open contacts for emptying.

Description Meaning

1. # = Cord Length
2. S = Standard Duty
3. V = Vertical Mechanical
4. D = Pump Down
5. 1 or 2 = 120 /240 Volts
6. WP = With Plug



V - Navigator

Pump Down



Mechanically activated, Vertical pump switch designed to control pumps up to 1/2 HP at 120 VAC and 1 HP at 240 VAC.

Part Number	Description	Cord Length	Voltage	Plug	Weight lbs.	List Price
20A201	10SVD1WP	10'	120	yes	2.2	\$49.31
20A202	10SVD2WP	10'	240	yes	2.2	\$51.51
20A203	15SVD1WP	15'	120	yes	2.8	\$52.61
20A204	15SVD2WP	15'	240	yes	2.8	\$54.82
20A205	20SVD1WP	20'	120	yes	3.4	\$55.92
20A206	20SVD2WP	20'	240	yes	3.4	\$58.13

* All floats can be purchased as "Bulk" for \$0.60 less than list price. Please change item description to a B. (i.e. 20A201 would be 20B201).

High AMP Mechanical Float Switch (1-1/2 Hp 120 v / 3 Hp 240 v)

BENEFITS & FEATURES

- Mechanically activated wide angle float to directly control a pump
- Not sensitive to rotation or turbulence
- For use in water and sewage applications
- Controls pumps up to 1-1/2 HP at 120 VAC, and 3 HP at 240 VAC
- Available for pump down applications
- Adjustable pumping range of 8 to 28 inches
- 12 gauge, 2 conductor, SJOW water resistant (CPE) material
- Max pump running current, 25 amps
- Max pump starting current, 96 amps
- 10', 15', 20', 30', 50' cord lengths for direct wiring only
- Individually boxed and includes SST pipe mount assembly
- UL / CSA
- 3 year limited warranty

Notes: 25 amp 12/2 SJOW wire; individually boxed, SST pipe mount assembly included with all floats.

PUMP DOWN designates normally open contacts for emptying.

Description Meaning

1. # = Cord Length
2. A = Amp Duty
3. M = Mechanical
4. D = Pump Down
5. NOP = No Plug



A - Navigator



Pump Down



Mechanically activated, pump switch designed to control pumps up to 1-1/2HP at 120 VAC and 3 HP at 240 VAC.

Part Number	Description	Cord Length	Voltage	Plug	Weight lbs.	List Price
20A301	10AMDNOP	10'	120/240	no	2.0	\$85.69
20A302	15AMDNOP	15'	120/240	no	2.2	\$89.00
20A303	20AMDNOP	20'	120/240	no	2.6	\$93.41
20A304	30AMDNOP	30'	120/240	no	3.0	\$100.02
20A305	50AMDNOP	50'	120/240	no	4.4	\$112.15

* All floats can be purchased as "Bulk" for \$0.60 less than list price. Please change item description to a B. (i.e. 20A301 would be 20B301).

Standard Duty Mercury Float Switch (1/2 Hp 120v / 1 Hp 240 v)



Junior
M - Navigator



BENEFITS & FEATURES

- Mercury activated wide angle float to directly control a pump
- Not sensitive to rotation or turbulence
- For use in water and sewage applications
- Controls pumps up to 1/2 HP at 120 VAC, and 1 HP at 240 VAC
- Available for pump up and pump down applications
- Adjustable pumping range of 6 to 36 inches
- 16 gauge, 2 conductor, SJOW water resistant (CPE) material
- Max pump running current, 13 amps
- Max pump starting current, 43 amps
- 10', 15', 20', 30', 50' cord with piggyback plug
- Individually boxed and includes SST pipe mount assembly
- UL / cUL
- 3 year limited warranty

Pump Down



Mercury-activated, 90 degree wide-angle pump switch designed to control pumps up to 1/2 HP at 120 VAC and 1 HP at 240 VAC.

Part Number	Description	Cord Length	Voltage	Plug	Weight lbs.	List Price	Notes: 13 amp 16/2 SJOW wire; individually boxed, SST pipe mount assembly included with all floats.
20A401	10SRDNOP	10'	120/240	no	1.6	\$40.69	PUMP DOWN designates normally open contacts for emptying.
20A402	10SRD1WP	10'	120	yes	2.8	\$46.20	
20A403	10SRD2WP	10'	240	yes	2.8	\$47.31	Description Meaning
20A407	15SRDNOP	15'	120/240	no	1.9	\$42.90	
20A408	15SRD1WP	15'	120	yes	3.0	\$48.41	1. # = Cord Length
20A409	15SRD2WP	15'	240	yes	3.0	\$49.51	2. S = Standard Duty
20A413	20SRDNOP	20'	120/240	no	2.1	\$45.10	3. R = Mercury
20A414	20SRD1WP	20'	120	yes	3.3	\$50.61	4. D or U = Pump Up or Pump Down
20A415	20SRD2WP	20'	240	yes	3.3	\$51.72	5. 1 or 2 = 120/240 Volts
20A419	30SRDNOP	30'	120/240	no	2.3	\$52.82	6. NOP or WP = No Plug or With Plug
20A420	30SRD1WP	30'	120	yes	3.5	\$58.33	
20A421	30SRD2WP	30'	240	yes	3.5	\$59.43	
20A425	50SRDNOP	50'	120/240	no	3.5	\$66.05	
20A426	50SRD1WP	50'	120	yes	4.7	\$71.56	
20A427	50SRD2WP	50'	240	yes	4.7	\$72.66	

Pump Up



Mercury-activated, 90 degree wide-angle pump switch designed to control pumps up to 1/2 HP at 120 VAC and 1 HP at 240 VAC.

Part Number	Description	Cord Length	Voltage	Plug	Weight lbs.	List Price	Notes: 13 amp 16/2 SJOW wire; individually boxed, SST pipe mount assembly included with all floats.
20A404	10SRUNOP	10'	120/240	no	1.6	\$40.69	PUMP UP designates normally closed contacts for filling.
20A405	10SRU1WP	10'	120	yes	2.8	\$46.20	
20A406	10SRU2WP	10'	240	yes	2.8	\$47.31	Description Meaning
20A410	15SRUNOP	15'	120/240	no	1.9	\$42.90	
20A411	15SRU1WP	15'	120	yes	3.0	\$48.41	1. # = Cord Length
20A412	15SRU2WP	15'	240	yes	3.0	\$49.51	2. S = Standard Duty
20A416	20SRUNOP	20'	120/240	no	2.1	\$45.10	3. R = Mercury
20A417	20SRU1WP	20'	120	yes	3.3	\$50.61	4. D or U = Pump Up or Pump Down
20A418	20SRU2WP	20'	240	yes	3.3	\$51.72	5. 1 or 2 = 120/240 Volts
20A422	30SRUNOP	30'	120/240	no	2.3	\$52.82	6. NOP or WP = No Plug or With Plug
20A423	30SRU1WP	30'	120	yes	3.5	\$58.33	
20A424	30SRU2WP	30'	240	yes	3.5	\$59.43	
20A428	50SRUNOP	50'	120/240	no	3.5	\$66.05	
20A429	50SRU1WP	50'	120	yes	4.7	\$71.56	
20A430	50SRU2WP	50'	240	yes	4.7	\$72.66	

* All floats can be purchased as "Bulk" for \$0.60 less than list price. Please change item description to a B. (i.e. 20A401 would be 20B401).

Call or fax us your order today. Phone: 601-939-2966 Fax: 601-939-3526 E-mail: joe@enviro-flo.net

Double Heavy Duty Mercury Float Switch (1 Hp 120 v / 2 Hp 240 v)

Double
M - Navigator

BENEFITS & FEATURES

- Mercury activated wide angle float to directly control a pump
- Not sensitive to rotation or turbulence
- For use in water and sewage applications
- Controls pumps up to 1 HP at 120 VAC, and 2 HP at 240 VAC
- Available for pump up and pump down applications
- Adjustable pumping range of 2 to 54 inches
- 14 gauge, 3 conductor, SJOW water resistant (CPE) material
- Max pump running current, 15 amps
- Max pump starting current, 96 amps
- 10', 20', 30', cord with piggyback plug
- Individually boxed and includes SST pipe mount assembly
- UL / CSA
- 3 year limited warranty

* Not recommended for use in drinking water applications.

Pump Down



Mercury-activated, 90 degree wide-angle pump switch designed to control pumps up to 1 HP at 120 VAC and 2 HP at 240 VAC.

Part Number	Description	Cord Length	Voltage	Plug	Weight lbs.	List Price
20A501	15DHRD1OP	15'	120	no	2.5	\$103.74
20A502	15DHRD2OP	15'	240	no	2.5	\$103.95
20A505	15DHRD1WP	15'	120	yes	2.7	\$107.42
20A506	15DHRD2WP	15'	240	yes	2.7	\$110.88
20A509	20DHRD1OP	20'	120	no	2.8	\$105.11
20A510	20DHRD2OP	20'	240	no	2.8	\$107.42
20A513	20DHRD1WP	20'	120	yes	3	\$110.88
20A514	20DHRD2WP	20'	240	yes	3	\$114.35
20A517	30DHRD1WP	30'	120	yes	3.6	\$120.12
20A518	30DHRD2WP	30'	240	yes	3.6	\$123.59

Notes: 15 amp 14/3 SJOW wire; individually boxed, SST pipe mount assembly included with all floats. PUMP DOWN designates normally open contacts for emptying.

Description Meaning

1. # = Cord Length
2. DH = Double Heavy Duty
3. R = Mercury
4. D or U = Pump Up or Pump Down
5. 1 or 2 = 120/240 Volts
6. OP or WP = No Plug or With Plug

* All floats can be purchased as "Bulk" for \$0.60 less than list price. Please change item description to a B. (i.e. 20A501 would be 20B501).

Pump Up



Mercury-activated, 90 degree wide-angle pump switch designed to control pumps up to 1 HP at 120 VAC and 2 HP at 240 VAC.

Part Number	Description	Cord Length	Voltage	Plug	Weight lbs.	List Price
20A503	15DHRU1OP	15'	120	no	2.5	\$101.64
20A504	15DHRU2OP	15'	240	no	2.5	\$103.95
20A507	15DHRU1WP	15'	120	yes	2.7	\$107.42
20A508	15DHRU2WP	15'	240	yes	2.7	\$110.88
20A511	20DHRU1OP	20'	120	no	2.8	\$105.11
20A512	20DHRU2OP	20'	240	no	2.8	\$107.42
20A515	20DHRU1WP	20'	120	yes	3	\$110.88
20A516	20DHRU2WP	20'	240	yes	3	\$114.35
20A519	30DHRU1WP	30'	120	yes	3.6	\$120.12
20A520	30DHRU2WP	30'	240	yes	3.6	\$123.59

Notes: 15 amp 14/3 SJOW wire; individually boxed, SST pipe mount assembly included with all floats. PUMP UP designates normally closed contacts for filling.

Description Meaning

1. # = Cord Length
2. DH = Double Heavy Duty
3. R = Mercury
4. D or U = Pump Up or Pump Down
5. 1 or 2 = 120/240 Volts
6. OP or WP = No Plug or With Plug

* All floats can be purchased as "Bulk" for \$0.60 less than list price. Please change item description to a B. (i.e. 20A501 would be 20B501).

**TETHER LENGTH VS. DRAWDOWN FOR
MECHANICAL WIDE ANGLE FLOAT SWITCHES**

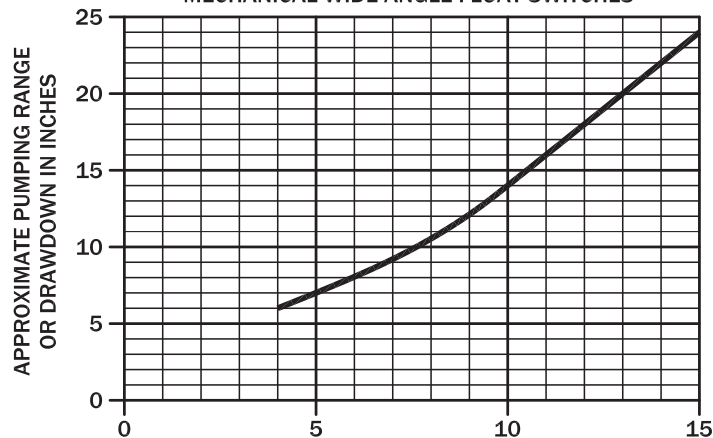

NOTE: FLOATS MUST HAVE A MINIMUM OF A 4" TETHER.

**TETHER LENGTH VS. DRAWDOWN FOR
MERCURY WIDE ANGLE FLOAT SWITCHES**

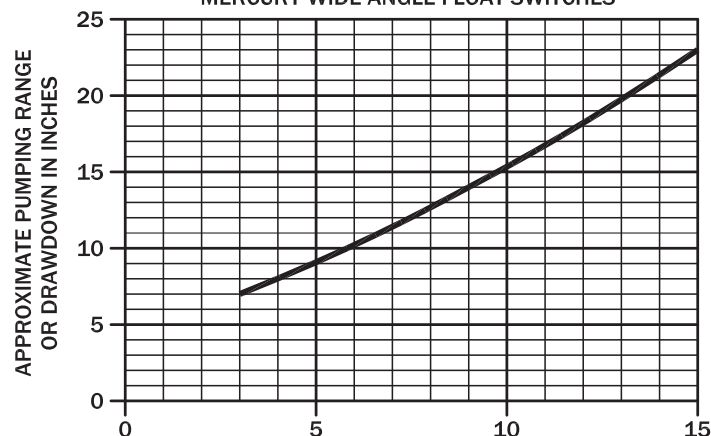

NOTE: FLOATS MUST HAVE A MINIMUM OF A 4" TETHER.

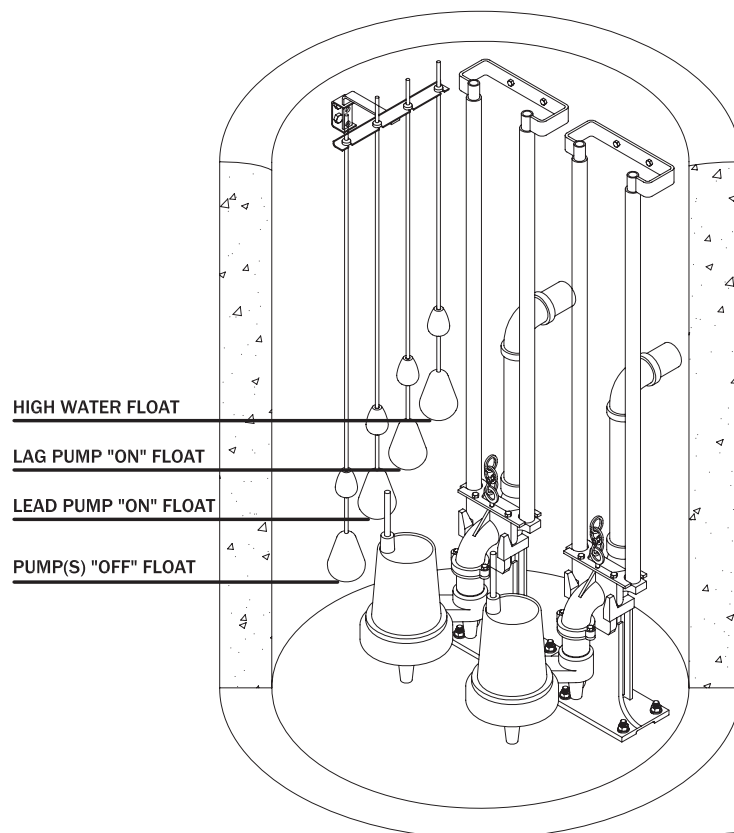
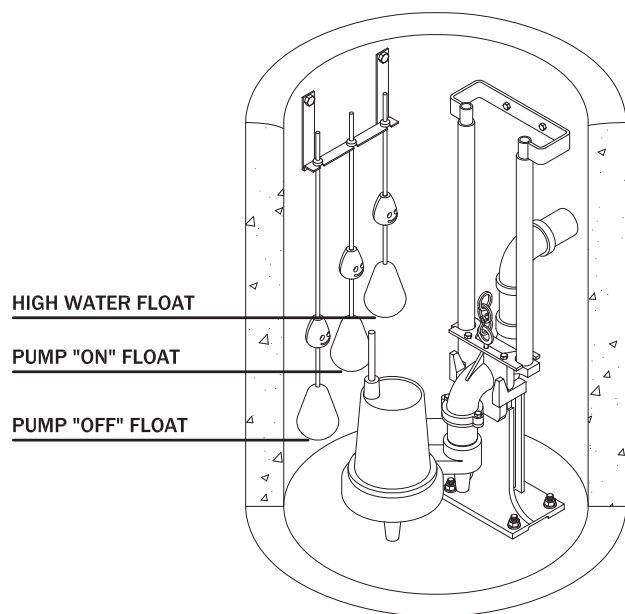

Single Light Control Panels

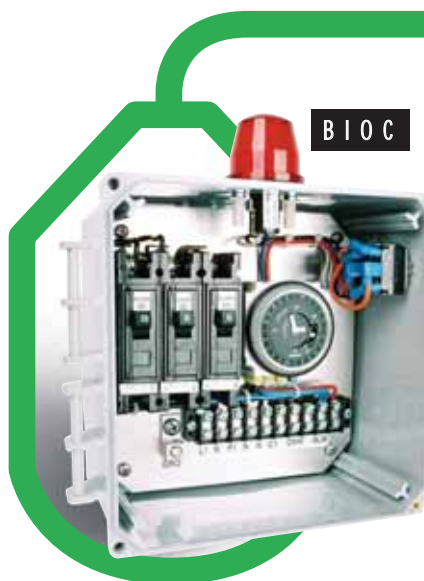

BIO C

BENEFITS & FEATURES

- Nema 4X enclosure (Lockable Latch Optional)
- Circuit breakers for pump, alarm, and compressor
- 24 hour timer available
- External run/test/mute switch standard
- External pump test switch (Optional on models C-PT & D-PT)
- External compressor air switch (Optional on models C-AV & D-AV)
- 360 degree red alarm light
- High decibel audible external buzzer
- External mounting feet
- Large field wiring terminal strips
- UL 508A panel listing
- Two-year limited warranty

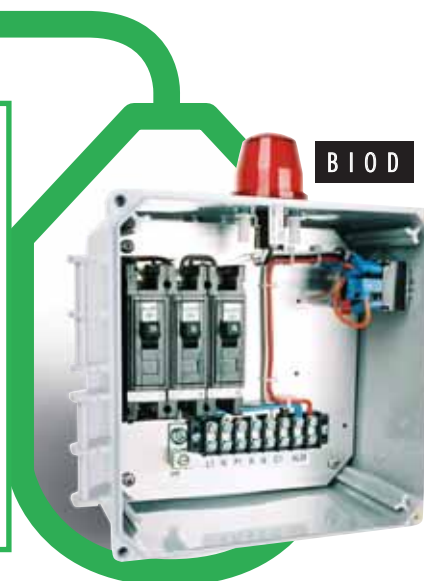

BIO D

Double Light Control Panels

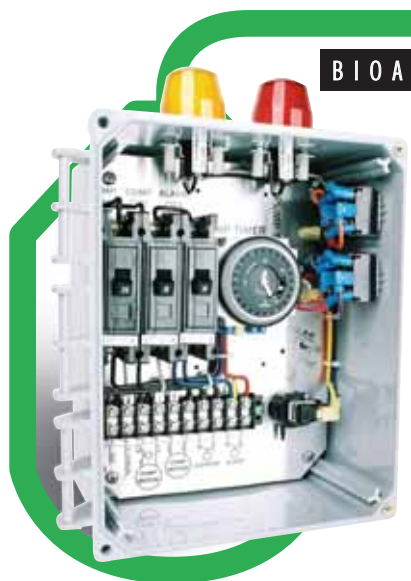

BIO A

BENEFITS & FEATURES

- Nema 4X enclosure (Lockable Latch Optional)
- Circuit breakers for pump, alarm, and compressor
- 24 hour timer or repeat cycle timer available
- External run/test/mute switch standard
- External or internal compressor air switch
- 360 degree red high water alarm light
- 360 degree yellow compressor fail alarm light
- High decibel audible external buzzer
- External mounting feet
- Large field wiring terminal strips
- UL 508A panel listing
- Two-year limited warranty

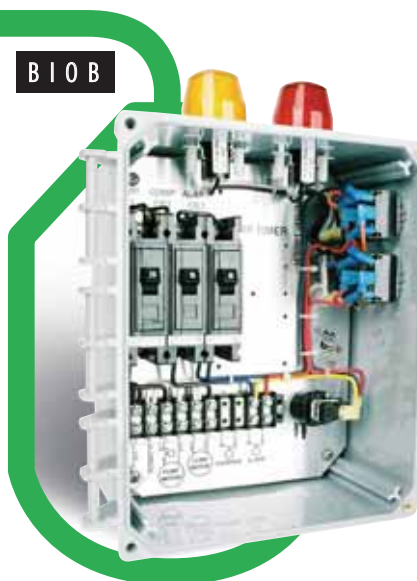

BIO B

Part Number	Model Number	Supply Voltage	Circuit Breakers	Timer	Air Switch	Lights / Buzzer	NEMA RATING	Shipping Weight	List Price
50B109	BIO CAV	120	3	yes	yes	Red	4X	5 lbs	\$358.94
50B003	BIO C	120	3	yes	no	Red	4X	5 lbs	\$348.53
50B005	BIO A	120	3	yes	yes	Red/Yellow	4X	6 lbs	\$373.50
50B006	BIO B	120	3	no	yes	Red/Yellow	4X	6 lbs	\$322.52
50B007	BIO D	120	3	no	no	Red	4X	5 lbs	\$322.52
50B008	BIO SN-T	120	3	yes	no	Red/Yellow	4X	6 lbs	\$405.76
50B009	BIO SN-2T	120	3	yes	no	Red/Yellow	4X	6 lbs	\$442.17
50B010	BIO HWA/P	120	2	no	no	Red	4X	4 lbs	\$272.58
50B017	120/240 D	120/240	2	yes	no	Red	4X	6 lbs	\$780.30
50B019	120/240 DD	120/240	3	yes	no	Red	4X	6 lbs	\$1,014.39
50B021	120/240 DT	120/240	3	yes	no	Red	4X	6 lbs	\$873.94
50B119	BIO D-PT	120	3	no	no	Red	4X	6 lbs	\$348.64
50B120	BIO C-PT	120	3	yes	no	Red	4X	6 lbs	\$374.03

Drip and Dosing Control Panels

DRIP 1



BENEFITS & FEATURES

- Nema 4X enclosure (Lockable Latch Optional)
- Simplex or Duplex models available
- Circuit breakers for pump and alarm
- Programmable logic controls for DRIP systems
- Repeat cycle timer and 24 hour timer options
- External run/test/mute switch standard
- "Hand/off/auto" heavy duty toggle
- 2 pole "definite purpose" contactor
- 360 degree red alarm light
- High decibel audible external buzzer
- External mounting feet
- Large field wiring terminal strips
- UL 508A panel listing
- Two-year limited warranty

BIO 120/240D



Rotary Vane Air Compressor

PUMP FEATURES

- Dual ball bearing design
- Durable cast iron construction
- Self contained pump end design
 - Easily removable from motor
 - Can be repaired and rebuilt
 - Front stabilizing pump foot
- Long life vane material
- Durable powder coat finish
- Two piece shaft coupling with spider
- Strong performance
- Ideal for aerobic treatment units

MOTOR FEATURES

- Dual ball bearing construction
- Durable 1/3 hp permanent split capacitor design
- Inner and outer cooling fans
- Quiet operation
- Rigid base with rubber feet to reduce vibration
- 6' Power cord with 115 volt plug
- Internal thermal overload

AR-07

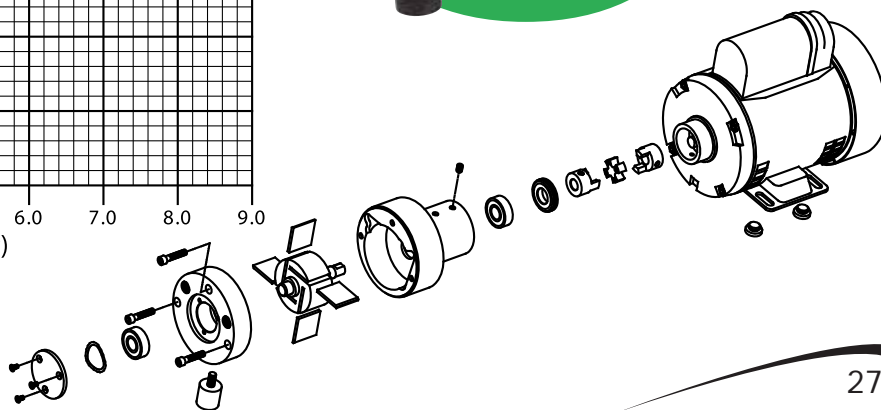
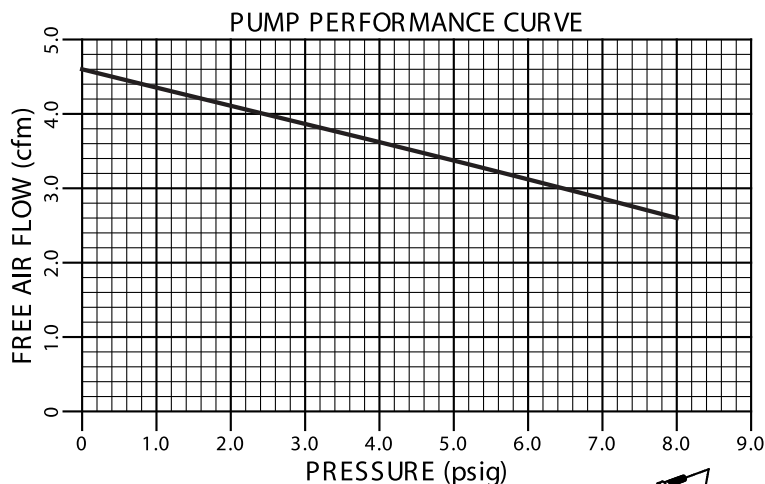

Simplex Control Panels (20 Amp Max)



SSC



BENEFITS & FEATURES

- 360 degree red alarm light
- Amber run light indicator
- High decibel audible buzzer
- NEMA 4X enclosure
- Stainless door latches w/padlock hasp
- External mounting feet
- 2 pole, "definite purpose" contactor (1Ø)
- "Hand/off/auto" heavy duty toggle
- Alarm "on/off/test" heavy duty toggle
- Field wiring terminal strips
- Motor circuit breaker
- 3 amp control/alarm circuit fuses
- UL 508A listing
- Color coded wiring
- Single and three phase panels available
- Two-year limited warranty

For additional options call the factory

Simplex Control Panel (2 HP Max) Single Phase Model "SSC"

Part Number	Model Number	Supply Voltage	FLA Range	Circuit Breaker	Control Fuse	Alarm Fuse	NEMA Rating	Shipping Weight	List Price W / Floats
50A001	SSC1B	120	0-20	yes	3 Amp	3 Amp	4X	13 lbs	\$535.81
50A002	SSC2B	208/240	0-20	yes	3 Amp	3 Amp	4X	13 lbs	\$567.02
50A003	SSC1NCB	120	0-20	no	3 Amp	3 Amp	4X	13 lbs	\$504.59
50A004	SSC2NCB	208/240	0-20	no	3 Amp	3 Amp	4X	13 lbs	\$515.00
50A006	SSC12B	120/240	0-20	yes	3 Amp	3 Amp	4X	13 lbs	\$567.02
50A007	SSC3B240	240 3Ø	0-11	yes	3 Amp	3 Amp	4X	13 lbs	\$1,300.50
50A008	SSC3B460	460 3Ø	0-11	yes	3 Amp	3 Amp	4X	13 lbs	\$1,794.69
50A016	SSC3B24	-	6-10	manual motor protector		3 Amp	4X	13 lbs	\$1,250.00

Notes: * Panels include 3 mechanical floats normally open with 15' cords.

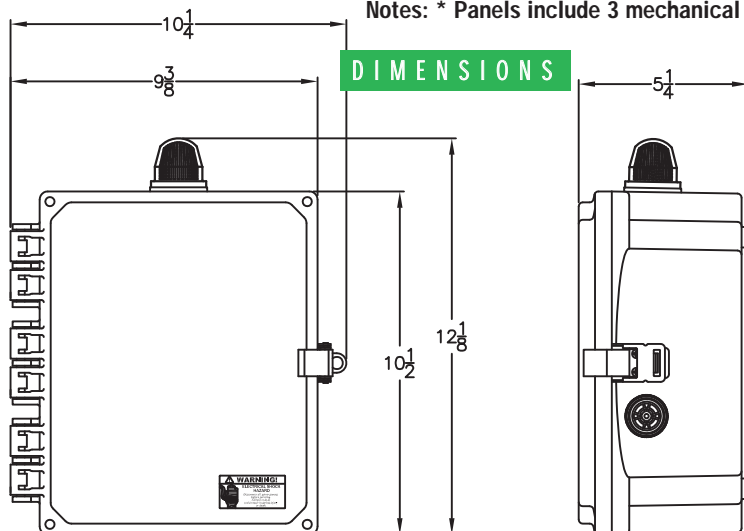

AVAILABLE OPTIONS (*)

- Fiberglass or SST Enclosures
- IEC Motor Contactor
- Flasher
- Dead Front Inner Doors
- Auxiliary Alarm Contacts
- Elapsed Time Meter
- Event or Cycle Counter
- Mercury or Mechanical Float Switches for the Pumps and High Water Alarm Circuits

Simplex Control Panels (20 Amp Max)

Installation information



SSC

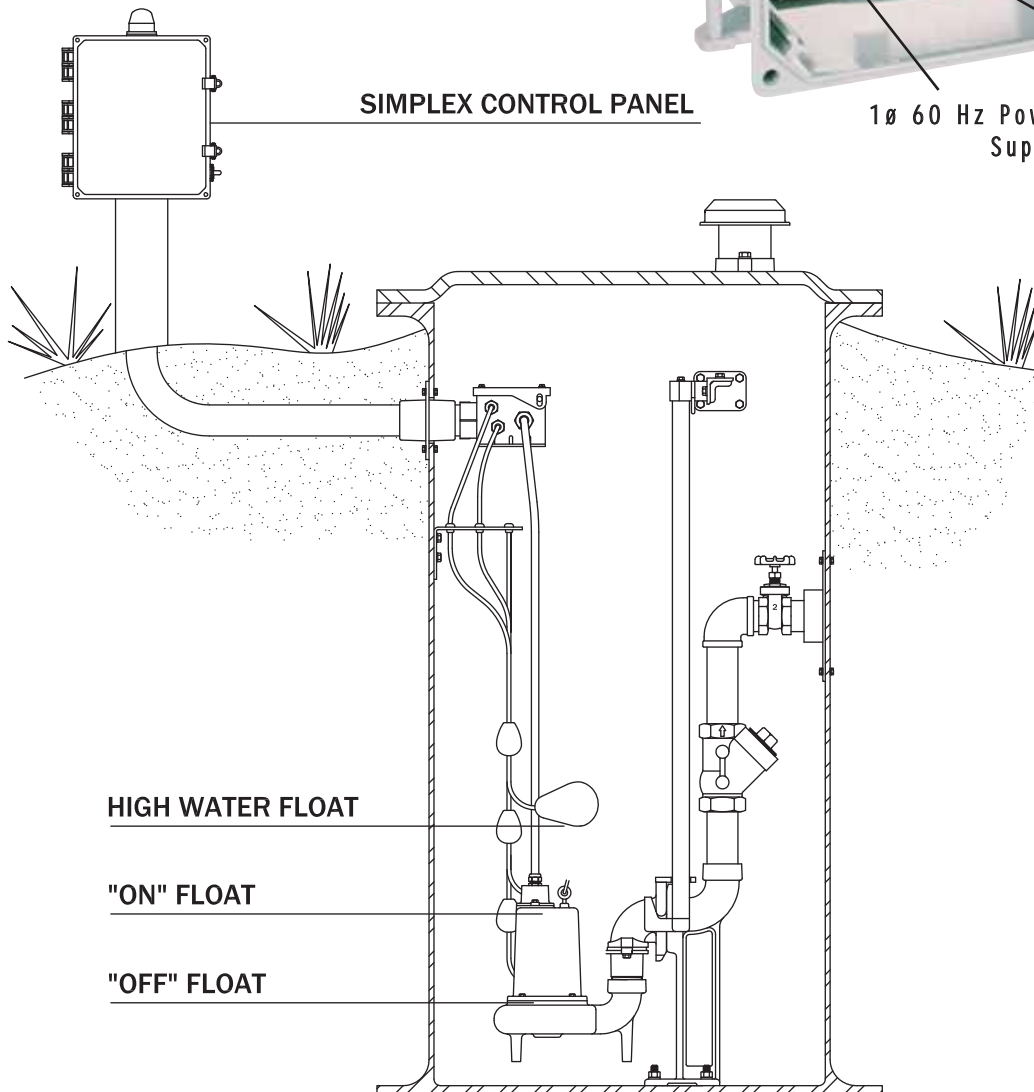
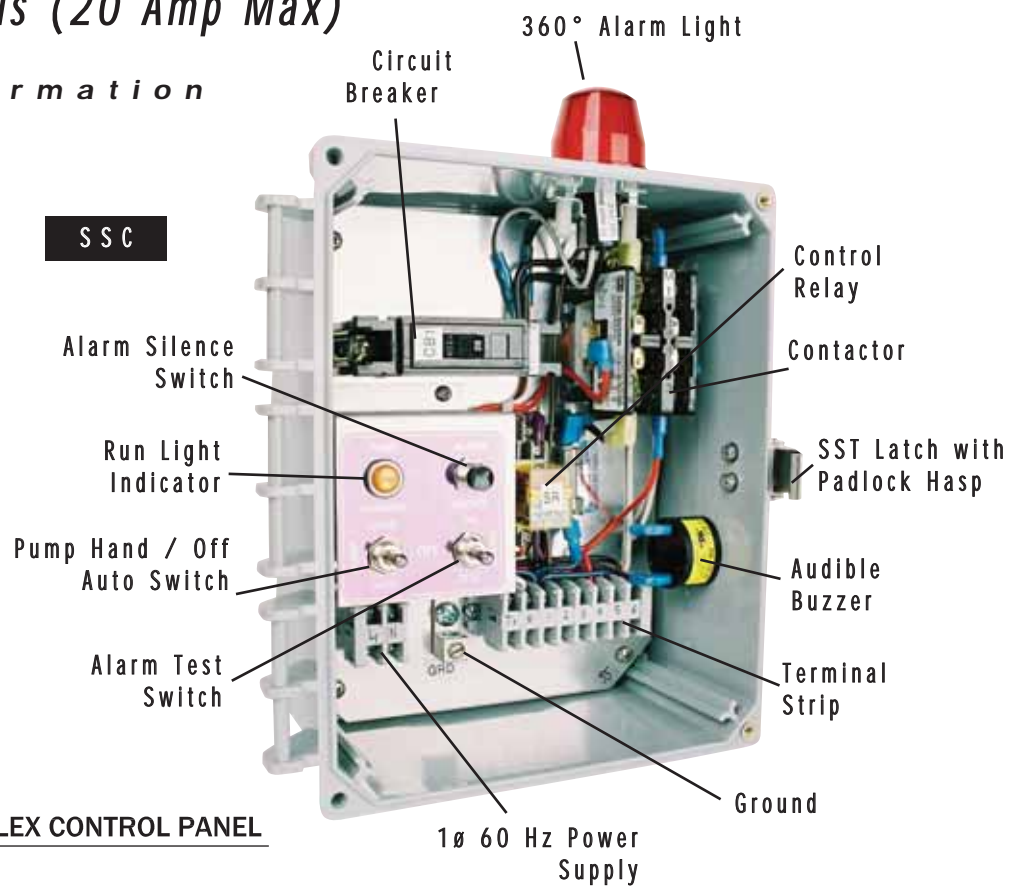

Duplex Control Panels (20 Amp Max)

SDC

BENEFITS & FEATURES

- 360 degree red alarm light
- 2 - amber run indicator lights
- High decibel audible buzzer
- NEMA 4X enclosure
- Stainless door latches w/padlock hasp
- External mounting feet
- Automatic alternating relay/override circuit
- 2 - 2 pole, "definite purpose" contactors (1Ø)
- 2 - "hand/off/auto" heavy duty toggles
- Alarm "on/off/test" heavy duty toggle
- Field wiring terminal strips
- 2 - motor circuit breakers
- 3 amp control/alarm circuit fuses
- UL 508A listing
- Color Coded wiring
- Single and three phase panels available (10 hp max)
- Two-year limited warranty

For additional options call the factory

Notes: * Panels include 3 mechanical floats with weights normally open with 15' cords.

Part Number	Model Number	Supply Voltage	FLA Range	Circuit Breaker	Control Fuse	Alarm Fuse	NEMA Rating	Shipping Weight	List Price W / Floats
50A501	SDC1B	120	0-20	yes	3 Amp	3 Amp	4X	13 lbs	\$837.52
50A502	SDC2B	208/240	0-20	yes	3 Amp	3 Amp	4X	13 lbs	\$889.54
50A503	SDC1NCB	120	0-20	no	3 Amp	3 Amp	4X	13 lbs	\$764.69
50A504	SDC2NCB	208/240	0-20	no	3 Amp	3 Amp	4X	13 lbs	\$816.71
50A506	SDC12B	120/240	0-20	yes	3 Amp	3 Amp	4X	13 lbs	\$889.54
50A509	SDC3B240	240 3Ø	0-11	yes	3 Amp	3 Amp	4X	13 lbs	\$2,028.78
50A510	SDC3B460	460 3Ø	0-11	yes	3 Amp	3 Amp	4X	13 lbs	\$2,957.86
50A516			6-11	manual motor protector		3 Amp	4X	13 lbs	\$1,992.88

DIMENSIONS

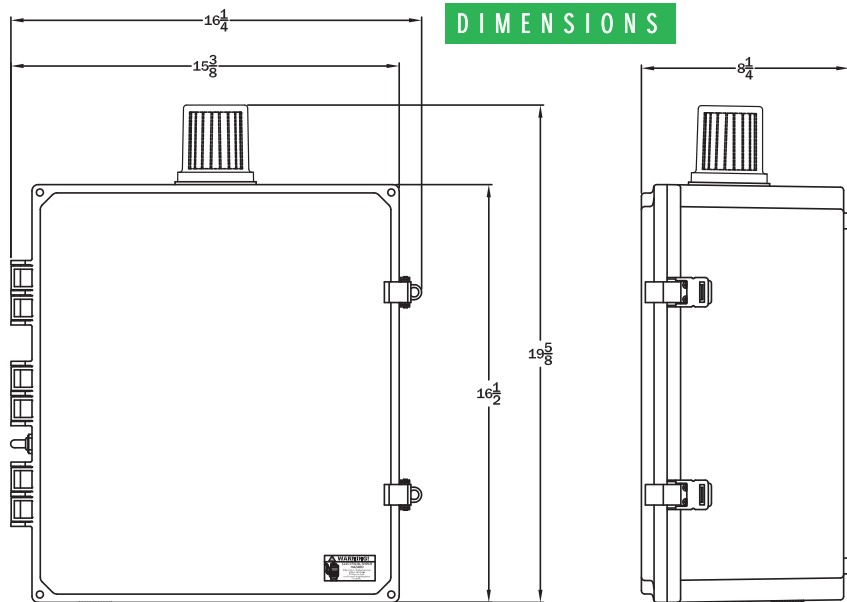

AVAILABLE OPTIONS (*)

- Fiberglass or SST Enclosures
- Alternating Relay with Selector Switch
- IEC Motor Contactor
- Flasher
- Dead Front Inner Doors
- Auxiliary Alarm Contacts
- Elapsed Time Meter
- Event or Cycle Counter
- Mercury or Mechanical Float Switches for the Pumps and High Water Alarm Circuits

Installation information

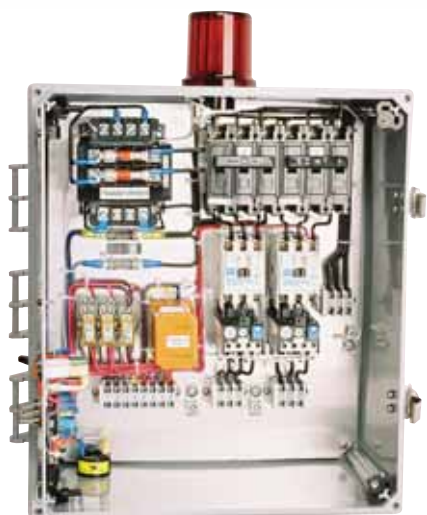

Three Phase Duplex Control Panel Available

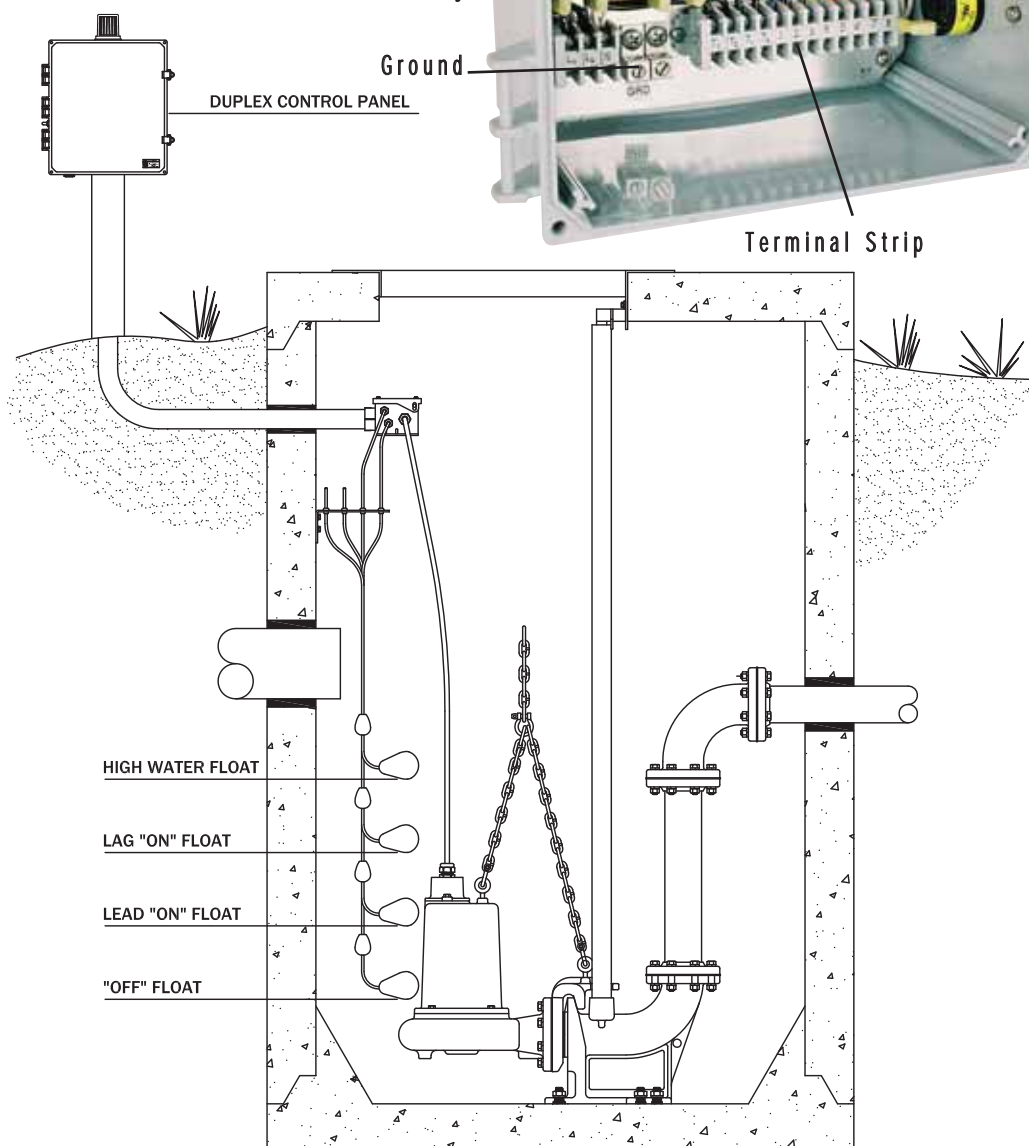
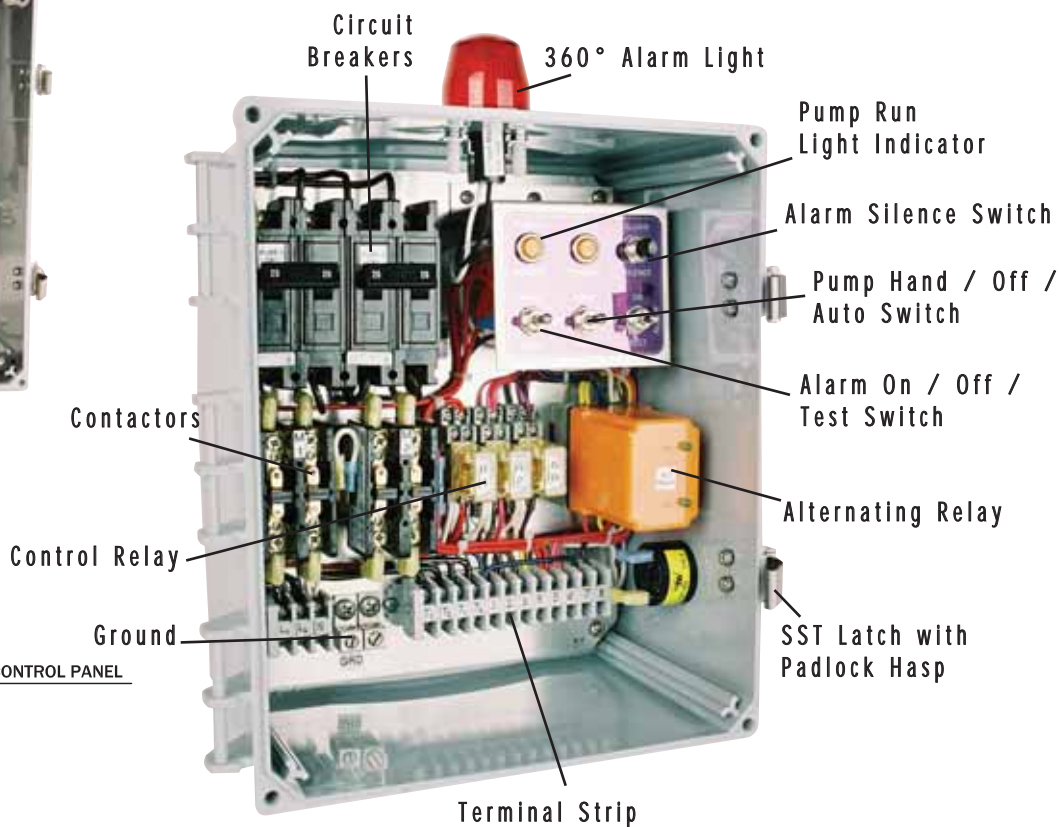

Timed Dosing Control Panels (20 Amp Max)

BENEFITS & FEATURES

- 360 degree red alarm light
- High decibel buzzer audible
- Nema 4X (10" X 12" X 6") enclosure
- Stainless door latches w/padlock hasp
- External mounting feet
- Repeat cycle timer
- 2 pole, "definite purpose" contactor
- "Hand/off/auto" heavy duty toggle
- Alarm "test/silence" heavy duty toggle
- Redundant off circuit (optional)
- Field wiring terminal strips
- Motor circuit breaker
- 3 amp control/alarm circuit fuses
- UL 508A listing
- Two year limited warranty



SSTD

Notes: * Panels include 3 mechanical floats with weights normally open with 15' cords.

Part Number	Model Number	Supply Voltage	FLA Range	Circuit Breaker	Control Fuse	Alarm Fuse	NEMA Rating	Shipping Weight	List Price W / Floats
50A801	SSTD1B	120	0-20	yes	3 Amp	3 Amp	4X	20 lbs	\$702.27
50A802	SSTD2B	208/240	0-20	yes	3 Amp	3 Amp	4X	20 lbs	\$737.54
50A806	SSTD12B	120/240	0-20	yes	3 Amp	3 Amp	4X	20 lbs	\$737.54
50A807	DRIP1	120	0-20	yes	3 Amp	3 Amp	4X	20 lbs	\$1,508.58

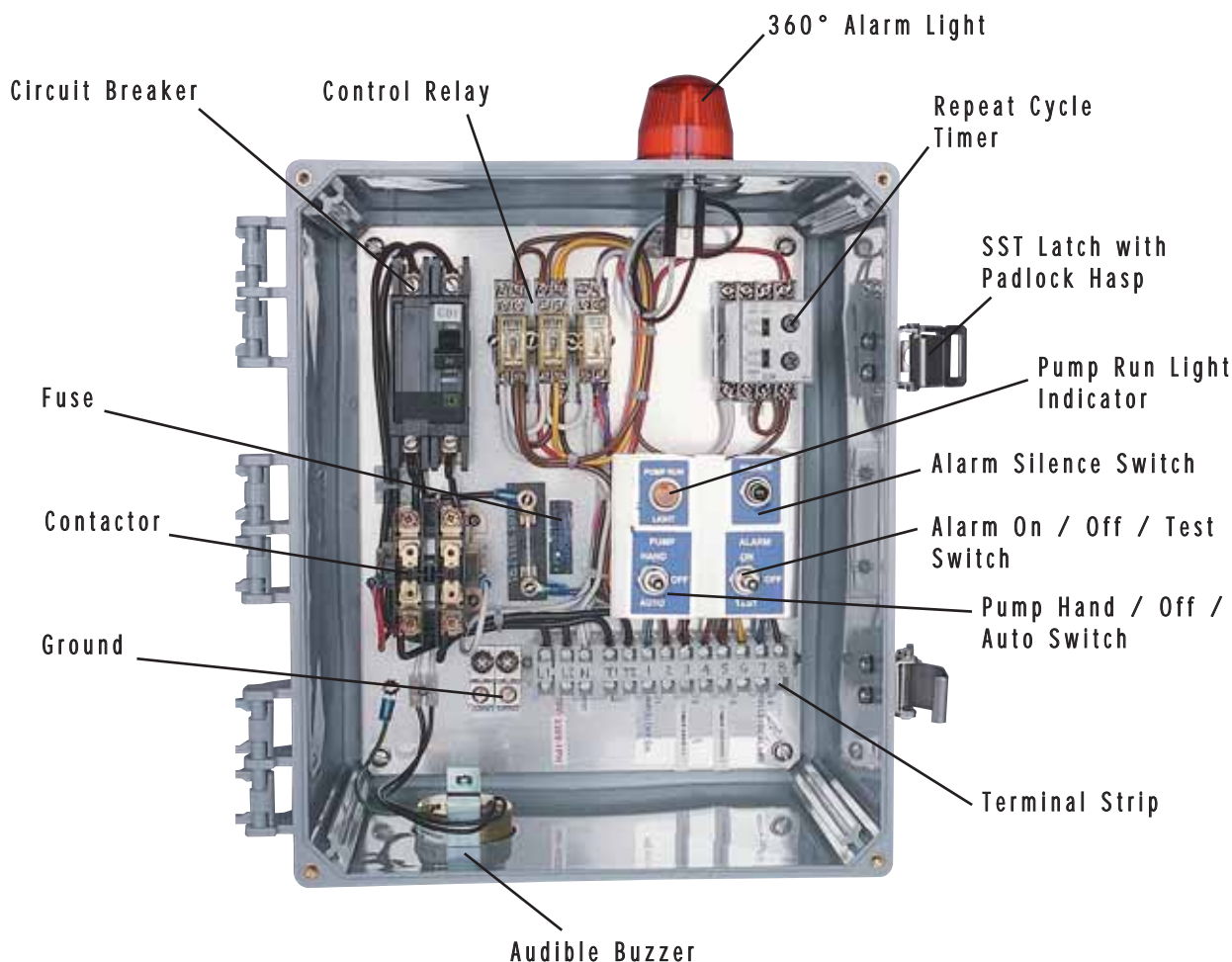

BENEFITS & FEATURES

- 360 degree red alarm light
- High decibel buzzer audible
- Nema 4X enclosure
- Stainless door latches w/padlock hasp
- External mounting feet
- Start cap/start relay/run cap
- IEC contactor
- "Hand/off/auto" heavy duty toggle
- Alarm "test/silence" heavy duty toggle
- Motor circuit breaker
- UL 508A listing
- Two year limited warranty

Control Panels for Grinders

GRD



Part Number	Model Number	Supply Voltage	FLA Range	Circuit Breaker	Control Fuse	Alarm Fuse	NEMA Rating	Shipping Weight	List Price W / Floats
50A700	GRD/SIM	230	0-20	yes	yes	yes	4X	20	\$754.00
50A750	GRD/DUP	230	0-20	yes	yes	yes	4X	26	\$1,350.00

* Start/Run components supplies for certain pump model. Please verify pump model.

Typical Grinder Layout

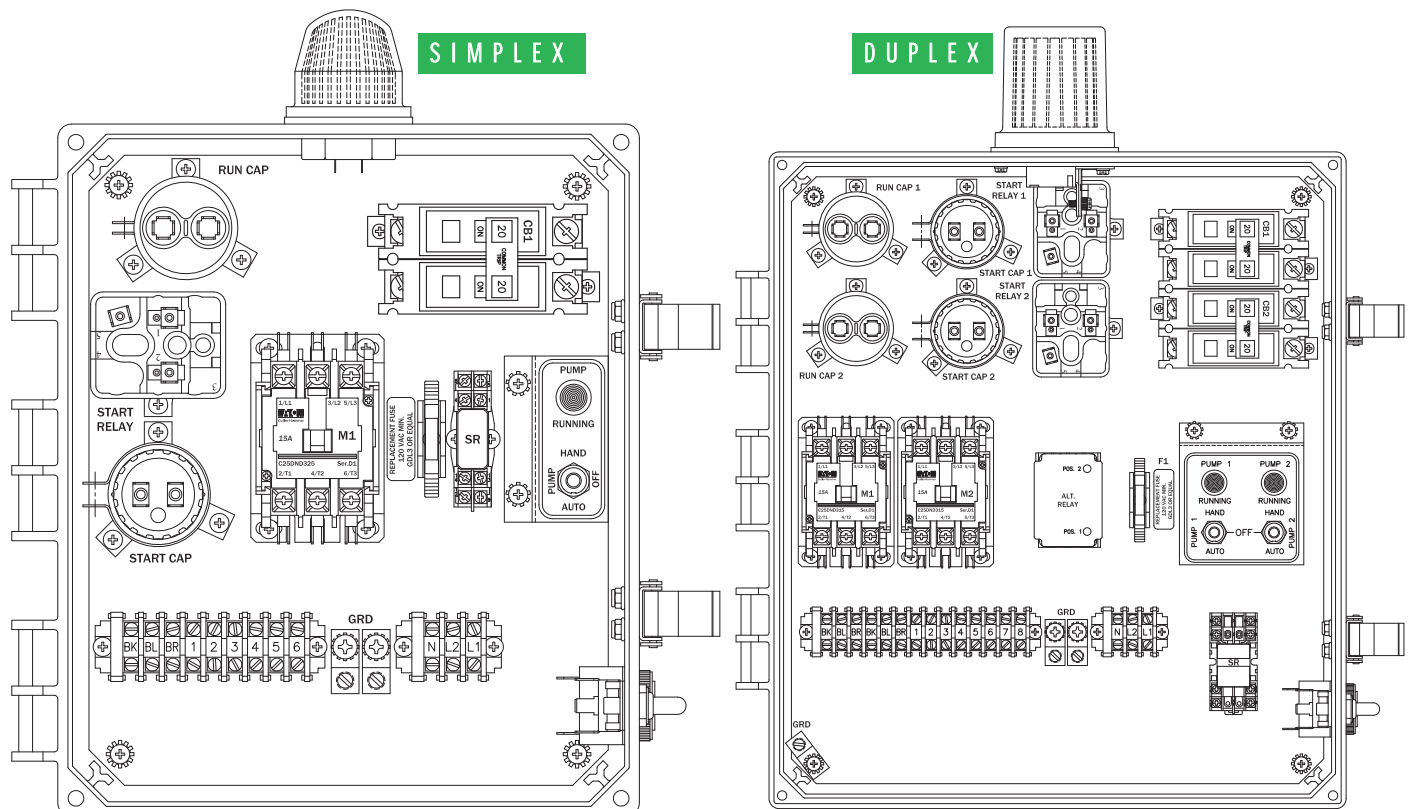

* Model 50A700 Series can not be returned.



--	--	--	--	--	--

Alarm Option Code:

Standard Configuration = Visual & Audible Alarm
On-Off-Test Switch
Silence Switch (internal)

E1 = Standard Enclosure w/Inner Door = \$70.00
E2 = Fiberglass Enclosure = \$95.00
E3 = Fiberglass Enclosure w/Inner Door = \$190.00

**Standard Configuration = Nema 4X
Polycarbonate w/SST latch**

F1 = Redundant Off + Standard = \$60.00
F2 = Low Level Alarm + Standard = \$60.00
F3 = No High Water Alarm Float = -\$30.00

Standard Configuration:

Simplex = "OFF", "ON", "High Water"
Duplex = "OFF", Lead "ON", "Lag "ON", "High Water"

MEF = Additional Float Switch w/weight = \$35.75
M10 = 10' Mercury w/weight = \$0.00
ME10 = 10' Mechanical w/weight = \$5.00
M15 = 15' Mercury w/weight = \$5.00
ME15 = 15' Mechanical w/weight = Standard
M20 = 20' Mercury w/weight = \$10.00
ME20 = 20' Mechanical w/weight = \$5.00
M30 = 30' Mercury w/weight = \$15.00
ME30 = 30' Mechanical w/weight = \$10.00

Standard Configuration: 3 – 15' Mechanical Switches w/weights

C1 = Elapsed Time Meter* = \$100.00
C2 = Cycle or Event Counter* = \$100.00
C3 = Auxiliary Contacts = \$38.00
C4 = Control Circuit Breaker = \$22.00
C5 = Lightning/Surge Arrestor** = \$180.00
C6 = Seal Leak Circuitry (2 wire)** = \$150.00
C7 = Motor Heat Sensor Connection = \$40.00
C8 = Anti-Condensation Heater** = \$260.00
C12 = Alternating Relay with Pump Lock Out Switch = \$40.00
C15 = External Pump Run Light = \$35.00
C16 = Basic Auto-Dialer** = Consult Factory
C20 = Separate Control Power Supply = Consult Factory

Note: When Pricing a Duplex Panel – 2 of the following options are required: C1, C2, C6, C7, C15.

The following option is available for duplex panels only: C12.

Consult Factory for Additional Options.

Some Items or Options can be mounted to an inner door upon request.

* = Any two of these options will required an enclosure size increase

** = Any one of these options will require an enclosure size increase

Total List Price = _____

--	--	--	--	--	--

Total List Price = _____

PVC Adaptaflex Fittings

Part Number	Model Number	Adaptaflex Grommets	Size inches	Hole Saw Size	Suggested List Price
60A200	AF38	Adaptaflex Grommet .375"	3/8"	1"	\$4.37
60A201	AF12	Adaptaflex Grommet .50"	1/2"	1-1/4"	\$4.48
60A202	AF34	Adaptaflex Grommet .75"	3/4"	1-1/4"	\$4.64
60A203	AF1	Adaptaflex Grommet 1.00"	1"	1-3/4"	\$4.75
60A204	AF1142	Adaptaflex Grommet 1.25" for 2" hole	1-1/4" X 2	2"	\$5.73
60A205	AF1143	Adaptaflex Grommet 1.25" for 3" hole	1-1/4" X 3	3"	\$5.73
60A206	AF112212	Adaptaflex Grommet 1.5" for 2-1/2" hole	1-1/2" X 2-1/2	2-1/2"	\$5.73
60A207	AF1123	Adaptaflex Grommet 1.5" for 3" hole	1-1/2" X 3	3"	\$5.73
60A208	AF2	Adaptaflex Grommet 2"	2"	3"	\$5.73
60A209	AF3	Adaptaflex Grommet 3"	3"	4"	\$7.10
60A210	AF32	Adaptaflex Grommet 3" X 2"	3" X 2	4"	\$9.83
60A211	AF435	Adaptaflex Grommet 4" SCH35	4" SDR35	5"	\$11.47
60A212	AF435S	Adaptaflex Grommet 4" SCH35 with retaining ring	4" SDR35	5"	\$11.47
60A213	AF4	Adaptaflex Grommet 4" SCH40	4"	5"	\$11.47
60A214	AF4S	Adaptaflex Grommet 4" SCH40 with retaining ring	4"	5"	\$11.47
60A215	AF635	Adaptaflex Grommet 6" SCH 35	6" SDR35	7"	\$17.47
60A216	AF6	Adaptaflex Grommet 6" SCH 40	6"	7"	\$17.47



P.O. Box 321161
 151 Custom Drive Flowood, MS 39232
 Office: 601-939-2966 Fax: 601-939-3526
 E-mail: joe@enviro-flo.net